

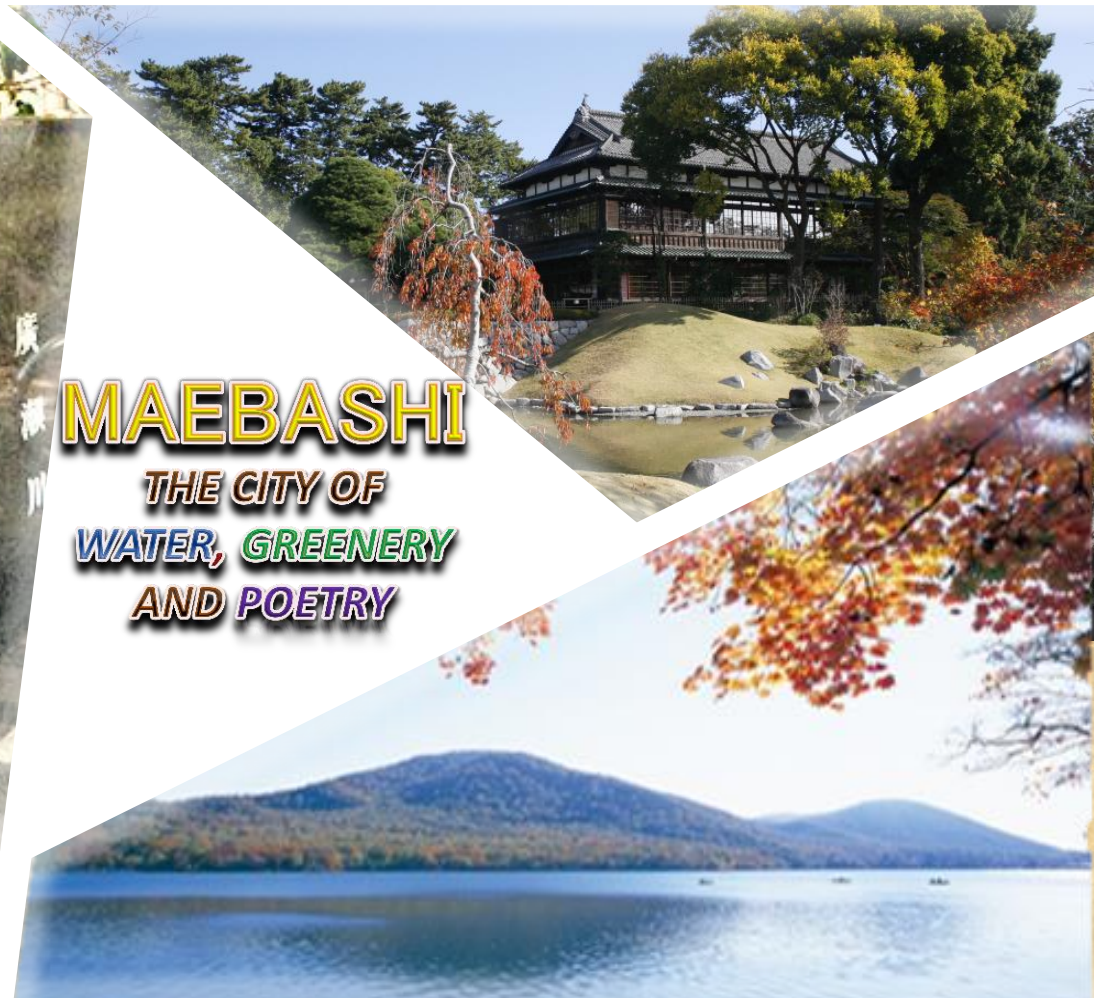

# AMT-BHI 2013

## 2013 International Conferences on Active Media Technology / Brain and Health Informatics



**MAEBASHI**  
THE CITY OF  
WATER, GREENERY  
AND POETRY

# PROGRAM

October 29-31, 2013, Maebashi, Gunma, Japan

# 2013 International Conferences on

Active Media Technology / Brain and Health Informatics

(AMT-BHI 2013)

---

## Program

---

October 29-31, 2013

Maebashi, Gunma, Japan

<http://wi-consortium.org/conferences/amtbi13>

# Corporate Sponsors



Web Intelligence Consortium

URL: <http://wi-consortium.org/>



Maebashi Institute of Technology

URL: <http://www.maebashi-it.ac.jp/>



Maebashi City Government

URL: <http://www.city.maebashi.gunma.jp/>



Gunma Prefecture Government

URL: <http://www.pref.gunma.jp/>



Maebashi Convention Bureau

URL: <http://www.maebashi-cvb.com>



IEEE Computational Intelligence Society

URL: <http://cis.ieee.org/>

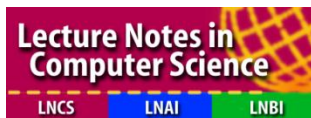

Springer

URL: <http://www.springer.com/>



Air Force Office of Scientific Research

URL: [www.tokyo.afosr.af.mil/](http://www.tokyo.afosr.af.mil/)



Asian Office of Aerospace Research  
and Development

URL: [www.tokyo.afosr.af.mil/](http://www.tokyo.afosr.af.mil/)



Tateisi Science and Technology Foundation

URL: <http://www.tateisi-f.org/>



Comprehensive Brain Science Network

URL: <https://www.hokatsu-nou.nips.ac.jp/>

有限会社 ウェブ・インテリジェンス・ラボ

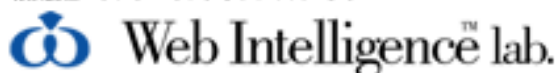

Web Intelligence Lab

URL: <http://www.wi-lab.com/wi-lab/>



Shoei CO. LTD.  
URL: <http://www.shoei-t.co.jp>



Japan High Comm CO. LTD.  
URL: <http://www.highcomm.co.jp/>



GCC Inc.  
URL: <http://www.gcc.co.jp/>



Yamato CO. LTD.  
URL: <http://www.yamato-se.co.jp/>



Kuribara Medical Instruments CO. LTD.  
URL: <http://www.kuribara.co.jp>



Mitsuba Gakki CO. LTD.  
URL: <http://www.mituba-kk.com/>

# Contents

Corporate Sponsors	i
Welcome Message from the Organizers	1
Information for Session Chairs and Presenters	3
Program at a Glance	5
Conference Program	8
AMT 2013 Type I Program	8
AMT 2013 Workshops/Special Sessions	11
AMT 2013 Type II Program	13
BHI 2013 Type I Program	14
BHI 2013 Workshops/Special Sessions	18
BHI 2013 Invited Special Sessions	22
BHI 2013 Type II Program	23
Keynote Abstracts	26
AMT-BHI Panel	33
Social Events	35
General Information	36
The conference Venue	39
Organization and Program Committee	49
Organization Committee AMT 2013	49
Program Committee AMT 2013	51
Organization Committee BHI 2013	53
Program Committee BHI 2013	55
Index	57
AMT 2013 Author Index	58
BHI 2013 Author Index	61

# Welcome Message from the Organizers

We are pleased to give you a warm welcome to the 2013 International Conferences on Active Media Technology (AMT 2013) and Brain and Health Informatics (BHI 2013). On behalf of the AMT-BHI 2013 joint Conference Committees, we would like to appreciate your participation and do hope that you will enjoy the conference technical and social programs.

The AMT-BHI 2013 joint Conference is co-organized by the Web Intelligence Consortium (WIC), IEEE Computational Intelligence Society Task Force on Brain Informatics (IEEE TF-BI), Maebashi Institute of Technology and Maebashi city.

AMT 2013 constitutes the ninth of the AMT series since the initial conference at Hong Kong Baptist University in 2001. Over the years, we witnessed many rapid scientific and technological developments in human-centered, seamless computing environments, interfaces, devices, and systems with applications ranging from business and communication to entertainment and learning. These developments are collectively best characterized as *active media technology*, a new area of intelligent information technology and computer science that emphasizes the proactive and seamless roles of interfaces and systems as well as new media in all aspects of digital life. AMT 2013 aimed at providing a leading international forum to bring together researchers and practitioners from diverse fields, to increase the cross-fertilization of ideas and explore the fundamental roles, interactions as well as practical impacts of intelligent information technology and computer science on the next generation of computing environments, systems, and media.

BHI 2013 is the first conference specifically dedicated to interdisciplinary research in brain and health informatics, which is extended from the series of Brain Informatics (BI) Conferences. The conferences on BI started with the First WICI International Workshop on Web Intelligence Meets Brain Informatics (WImBI 2006), held in Beijing, China, in 2006. BI is an interdisciplinary research field that focuses on studying the mechanisms underlying the thinking-oriented human information processing system (HIPS) by means of experimental, computational, and cognitive neuroscience studies, not least utilizing advanced Web intelligence (WI)-centric information technologies. The integration of BI and HI will preferably transfuse the advanced information technology into human-related research. BHI has two objectives: one is to capture new forms of collaborative and interdisciplinary work focusing on the information and communication technologies (ICT), to connect the human body to its ultimate product, i.e., thinking; the other is to develop and disseminate the understanding of novel, intelligent computing formalisms and related technologies in the context of brain and health/well-being-related studies and services. BHI will bring a potentially revolutionary shift in the way that research is undertaken in health sciences as a whole.

We are confident that AMT-BHI 2013 stands as a leading international forum for researchers and practitioners to present state-of-art progresses and insights. It makes available a unique opportunity for the exchange of experiences and ideas and for multi-disciplinary and especially academia-industry collaborations and cross-fertilizations in the expanded fields of AMT and BHI.

On behalf of the AMT-BHI 2013 Conference Committees, we would like to thank all authors, presenters, keynote speakers, panelists, workshop/special session organizers, and all members of the International Program

Committee for their substantive contributions towards the high quality of the AMT-BHI 2013 conference. We would also like to thank the sponsors for their valuable support. Last but not the least, we are extraordinarily appreciative for the tremendous and most effective administrative and secretarial support from the local host and local organizing team, without which the success of the conference's organization would not be possible.

We all look forward to many excellent technical and social interactions during this 3-day joint conference. We encourage all of you to fully participate in the technical and social events.

Finally, we wish you an enjoyable and impressive meeting in Maebashi, and we thank you for attending!

**AMT-BHI'13 Honorary General Chair**

Setsuo Ohsuga, University of Tokyo, Japan

**AMT-BHI'13 Organizing Chairs**

Kazuyuki Imamura, Maebashi Institute of Technology, Japan

Tetsumi Harakawa, Maebashi Institute of Technology, Japan

Ning Zhong, Maebashi Institute of Technology, Japan

**AMT'13 Conference General Chairs**

Andrzej Skowron, University of Warsaw, Poland

Jian-Nong Cao, Hong Kong Polytechnic University, Hong Kong SAR, China

**BHI'13 Conference General Chairs**

Tomoaki Shirao, Graduate School of Medicine, Gunma University, Japan

Takuji Kasamatsu, Maebashi Institute of Technology, Japan

**AMT'13 Program Chairs**

Tetsuya Yoshida, Hokkaido University, Japan

Gang Kou, University of Electronic Science and Technology of China, China

**BHI'13 Program Chairs**

Kazuyuki Imamura, Maebashi Institute of Technology, Japan

Shiro Usui, Toyohashi University of Technology, Japan



# Information for Session Chairs and Presenters

## *Facilities at the Presentation Room*

Each presentation room is equipped with a video projector (without PC). It is suggested that attendees bring their own laptops and USB flash memories to the presentation rooms. If something is not working properly, please contact the volunteer who will be in charge of the room (a volunteer is assigned to each room during the presentations).

## *Presentation Time*

The time allocated to each presentation is given on the timetable (including questions and answers): 20 minutes for Type I and 15 minutes for Type II.

## *Session Chairs*

If you cannot fulfill your duties as a session chair, please ensure that someone else will take your place as the session chair and inform the Conference Chair.

Session chairs are kindly requested to help with the followings:

1. Note the time allocated for each paper in your session. Each paper is allocated 20 minutes (15 to 17 minutes for the presentation plus 3 to 5 minutes for discussion) for Type I and 15 minutes (11 to 13 minutes for the presentation plus 2 to 4 minutes for discussions) for Type II.
2. Arrive at the room of the session at least 5 minutes before the session starts and identify each of the speakers for the session.
3. Suggest each speaker to keep corresponding time for discussions (questions and answers), and for transition to the next presentation. If a presentation extends into the time for discussions, please shorten the discussions accordingly or postpone the discussions until after the session.

4. Do not allow presentations or the subsequent discussions to spill beyond the starting time of the next presentations.
5. If the presenter of a paper is absent (no-show), please continue to the next presentation. Please check again at the end of the last presentation whether the no-show shows up. Best efforts have been made to reduce the number of no-shows; however, they may not be eliminated. After your session, please inform the Conference Chair of the paper(s) that have not been presented.

## ***Presenters***

Please check your presentation time and room (an index can be used at the end of this booklet). Please go to room 5 minutes before the session starts and identify yourself to the session chairs.

1. Note the time allocated for each paper is 20 minutes (15 to 17 minutes for the presentation plus 3 to 5 minutes for discussion) for Type I and 15 minutes (11 to 13 minutes for the presentation plus 2 to 4 minutes for discussions) for Type II.
2. When it is your turn to present, please leave corresponding time for discussion (questions and answers), and for transition to the next presentation. If your presentation extends into the time for discussions, discussions on your paper will be shortened by the session chair accordingly or postponed until after the session.
3. Please do not exceed your allocated time. Please follow the instructions of the Session Chairs.

If you cannot find your name in Sessions or your information is incorrect in the Program Booklet, please contact the Conference Chairs.

# Program at a Glance

## Tuesday, October 29

	Room A 2F Hall	Room B 8F KEYAKI	Room C 4F KENSHU-3	Room D 9F TSUTSUI-1	Room E 9F TSUTSUI-2	Room F 9F ASAMA	Room G 9F AKAGI	Room H 9F HARUNA	Room I 9F MYOGI
09:00 – 09:30	Opening								
09:30 – 10:30	BHI Special Keynote Lecture Shinsuke Shimajo								
10:30 – 10:50	Coffee Break (2F Corridor)								
10:50 – 11:50	AMT Keynote Lecture Carl K. Chang								
11:50 – 12:50	AMT Keynote Lecture Andrzej Skowron								
12:50 – 14:00	Lunch 2F Hall (Mini-concert by the orchestral music circle of Maebashi Institute of Technology, about 30 Minutes)								
14:00 – 16:00 *		BHI Special Session on Cutting Edge Research of Neuroinformatics in the Clinical Research 5 Presentations	Unavailable	AMT-T1 Active Media Machine Learning and Data Mining Techniques I 4 Presentations	BHI Workshop on Granular Knowledge Discovery in Biomedical & Active- Media Environments 5 Presentations	AMT Workshop on Intelligence for Strategic Foresight 4 Presentations	BHI-T1 Thinking and Perception-Centric Investigations of Human Information Processing System I 4 Presentations	BHI-T2 Information Technologies for Curating, Mining, Managing, and Processing Big Brain/Health Data 4 Presentations	BHI-T2 Healthcare Decision Support 5 Presentations
16:00 – 18:00		Preparation	Unavailable	AMT-T1 Active Computer Systems, Interactive Applications of AMT Based Systems I 4 Presentations	BHI Workshop on Mental Healthcare with ICT 3 Presentations	AMT Special Session on Theories of Narrative Technologies and 4 Presentations	BHI-T1 Information Technologies for Curating, Mining, Managing and Using Big Brain/Health Data 4 Presentations	BHI-T2 Thinking and Perception-Centric Investigations of Human Information Processing Systems I 6 Presentations	BHI-T2 Applications in BHI 4 Presentations
18:00 – 20:00		Welcome Reception							

\* Depending on the number of presentations, the ending time may vary across sessions. Beverage is freely available on the 8th floor for waiting.

Wednesday, October 30

	Room A 2F Hall	Room B 8F KEYAKI	Room C 4F KENSHU-3	Room D 9F TSUTSUJI-1	Room E 9F TSUTSUJI-2	Room F 9F ASAMA	Room G 9F AKAGI	Room H 9F HARUNA	Room I 9F MYOGI
09:00 – 11:00 *	Preparation	AMT-T1 AMT for Semantic Web, Social Networks, and Cognitive Foundations I 5 Presentations	AMT-T1 Active Media Machine Learning and Data Mining Techniques II 5 Presentations	AMT Special Session on Evolutionary Computation and Its Application 5 Presentations	BHI Special Session on Human Centered Computing 4 Presentations	BHI Special Session on Neuro-Robotics 4 Presentations	BHI-T1 Thinking and Perception-Centric Investigations of Human Information Processing System II 4 Presentations	BHI-T1 Information Technologies for Healthcare I 4 Presentations	BHI-T1 Data Analytics, Data Mining, and Machine Learning 4 Presentations
11:00 – 13:00		AMT-T1 AMT for Semantic Web, Social Networks, and Cognitive Foundations II 5 Presentations	AMT-T1 Active Computer Systems, Interactive Systems, and Applications of AMT Based Systems II 4 Presentations	AMT Special Session on Intelligent Media Search Techniques 4 Presentations	BHI Special Session on Intelligent Healthcare Data Analytics 4 Presentations	BHI BHI Workshop on Biological Database Analysis for Health Science 7 Presentations	BHI-T1 Thinking and Perception-Centric Investigations of Human Information Processing System III 4 Presentations	BHI-T1 Information Technologies for Healthcare II 4 Presentations	BHI Special Session on Monitoring and Control of Biosignaling 3 Presentations
13:00 – 14:00	Lunch 2F Hall (Mini-concert by Gunma Univ. Mandolin Society, about 30 Minutes)								
14:00 – 15:00	Special AMT-BHI Joint Keynote Yuichiro Anzai	Preparation							
15:00 – 15:30	Coffee Break (2F Corridor)								
15:30 – 17:30	Panel	Preparation							
18:00 – 20:00		Banquet							

\* Depending on the number of presentations, the ending time may vary across sessions. Beverage is freely available on the 8th floor for waiting.

**Thursday, October 31**

	Room A	Room B	Room C	Room D	Room E	Room F	Room G	Room H	Room I
09:00 – 10:00	2F Hall AMT Keynote Lecture Yuzuru Tamaka	8F KEYAKI	4F KENSHU-3	9F TSUTSUJI-1	9F TSUTSUJI-2	9F ASAMA	9F AKAGI	9F HARUNA	9F MYOGI
10:00 – 10:20	Coffee Break (2F Corridor)								
10:20 – 11:20	BHI Keynote Lecture Marcel A. Just								
11:20 – 12:20	BHI Keynote Lecture Jiming Liu								
12:20 – 13:30	Lunch 2F Hall (Image Demonstration of Gunma Prefecture and Maebashi-City, about 30 Minutes)								
13:30 – 15:30		Invited Special Session on Solving the Mystery of Sleep 5 Presentations		Invited Special Session on Heavy Ion Irradiation Therapy: Synergy of Medical and Engineering Sciences 4 Presentations	BHI-T1 Applications in BHI 5 Presentations	AMT-T2 AMT Based Support Systems and Technologies 4 Presentations	BHI-T2 Thinking and Perception-Centric Investigations of Human Information Processing Systems II 6 Presentations	BHI-T2 Information Technologies for Healthcare Delivery and Management 4 Presentations	AMT-T2 Information Retrieval and Data Mining 5 Presentations
15:45 – 18:00	<p>Optional Tours (Gathering at lobby on 15:45, and starting the visit on 16:00)</p> <p>Tour 1: Visit to Gunma University Heavy Ion Medical Center (Up to 40 people)</p> <p>Tour 2: Visit to the Rinkoukaku – An Important Cultural Property</p> <p>The two groups will visit the Gunma Prefectural Government Building after the Optional Tours</p>								

# AMT 2013 Type I Program

*Tuesday, October 29, 2013*

## *Active Media Machine Learning and Data Mining Techniques I*

Session Chairs: Tetsuya Yoshida and Kenichi Ida

Session Time: 2:00pm- 4:00pm

Location: **Room D** (9F TSUTSUJI-1)

- A215** Learning and Utilizing a Pool of Features in Non-Negative Matrix Factorization  
Tetsuya Yoshida
- A216** Information and Rough Set Theory Based Feature Selection Techniques  
Liam Cervante and Xiaoying Gao
- A221** Research on the Algorithm of Semi-Supervised Robust Facial Expression Recognition  
Bin Jiang, Kebin Jia, and Zhonghua Sun
- A223** Theoretical Analysis and Evaluation of Topic Graph Based Transfer Learning  
Tetsuya Yoshida and Hiroki Ogino

## *Active Computer Systems, Interactive Systems, and Applications of AMT Based Systems I*

Session Chairs: Yasushi Kambayashi and Masahito Hirakawa

Session Time: 4:00pm- 6:00pm

Location: **Room D** (9F TSUTSUJI-1)

- A205** Vision-Based User Interface for Mouse and Multi-Mouse System  
Yuki Onodera and Yasushi Kambayashi
- A213** Gamification of Community Policing: SpamCombat  
Alton Y.K. Chua and Snehasish Banerjee
- A229** Wi-Fi RSS Based Indoor Positioning Using a Probabilistic Reduced Estimator  
Gang Shen and Zegang Xie
- A237** Identifying Individuals' Footsteps Walking on a Floor Sensor Device  
Kiryu Ibara, Kenta Kanetsuna, and Masahito Hirakawa

## ***Wednesday, October 30, 2013***

### ***AMT for Semantic Web, Social Networks, and Cognitive Foundations I***

Session Chairs: Gang Shen and Tatsuo Nakajima

Session Time: 9:00am- 11:00am

Location: **Room B** (8F KEYAKI)

- A217** Basic Study on Treating Tinnitus with Brain Cognition Sound  
Takeya Toyama, Daishi Takahashi, Yousuke Taguchi, and Ichiro Fukumoto
  
- A219** The Roles of Environmental Noises and Opinion Leaders in Emergency  
Yiyi Zhao and Yi Peng
  
- A224** Task Context Modeling for User Assist in Organizational Work  
Masashi Katsumata
  
- A226** Designing Enhanced Daily Digital Artifacts Based on the Analysis of Product Promotions  
Using Fictional Animation Stories  
Mizuki Sakamoto, Tatsuo Nakajima, and Sayaka Akioka
  
- A251** Online Visualisation of Google Images Results  
Gerald Schaefer, David Edmundson, and Shao Ying Zhu

### ***Active Media Machine Learning and Data Mining Techniques II***

Session Chairs: Yoshitsugu Kakemoto and Songrit Maneewongvatana

Session Time: 9:00am- 11:00am

Location: **Room C** (4F KENSHU-3)

- A245** Identification of K-Tolerance Regulatory Modules in Time Series Gene Expression Data  
Using a Biclustering Algorithm  
Tustanah Phukhachee and Songrit Maneewongvatana
  
- A246** Selective Weight Update for Neural Network -Its Backgrounds  
Yoshitsugu Kakemoto and Shinichi Nakasuka
  
- A247** Developing Transferable Clickstream Analytic Models Using Sequential Pattern Evaluation  
Indices  
Hidenao Abe
  
- A256** Toward Robust and Fast Two-Dimensional Linear Discriminant Analysis  
Tetsuya Yoshida and Yuu Yamada
  
- A235** Customer Rating Prediction Using Hypergraph Kernel Based Classification  
Fateme Kaveh-Yazdy, Xiangjie Kong, Jie Li, Fengqi Li, and Feng Xia

### ***AMT for Semantic Web, Social Networks, and Cognitive Foundations II***

Session Chairs: Remo Job and Ali Akbar Ghorbani

Session Time: 11:00am- 1:00pm

Location: **Room B** (8F KEYAKI)

- A233** Technology and Cognition: Does the Device We Use Constrain the Way We Retrieve Word Meanings?  
Tania Cerni and Remo Job
- A244** Semantically Modeling Mobile Phone Data for Urban Computing  
Hui Wang, Zhisheng Huang, Ning Zhong, and Jiajin Huang
- A250** Lexical-Syntactical Patterns for Subjectivity Analysis of Social Issues  
Mostafa Karamibekr and Ali Akbar Ghorbani
- A255** Action Unit-Based Linked Data for Facial Emotion Recognition  
Kosuke Kaneko and Yoshihiro Okada

### ***Active Computer Systems, Interactive Systems, and Applications of AMT Based Systems II***

Session Chairs: Yasser Mohammad and Juichi Kosakaya

Session Time: 11:00am- 1:00pm

Location: **Room C** (4F KENSHU-3)

- A241** An Automated Musical Scoring System for Tsugaru Shamisen by Multi-Agent Method  
Juichi Kosakaya
- A243** Detection and Presentation of Failure of Learning from Quiz Responses in Course Management Systems  
Toshiyasu Kato and Takashi Ishikawa
- A252** Tackling the Correspondence Problem: Closed-Form Solution for Gesture Imitation by a Humanoid's Upper Body  
Yasser Mohammad and Toyoaki Nishida
- A257** Visualization of Life Patterns through Deformation of Maps Based on Users' Movement Data  
Hayato Yokoi, Kohei Matsumura, and Yasuyuki Sumi



# AMT 2013 Workshops/Special Sessions

*Tuesday, October 29, 2013*

## ***Workshop on Intelligence for Strategic Foresight***

Session Chairs: Hanmin Jung, Seungwoo Lee and Sa-Kwang Song

Session Time: 2:00pm-4:00pm

Location: **Room F** (9F ASAMA)

- SA2201** Selection of Core Technologies from Scientific Document  
Myungwon Hwang, Jangwon Gim, Do-Heon Jeong, Jinhung Kim, Sa-kwang Song, Sajjad Mazhar, Hanmin Jung, and Jung-Hoon Park
- SA2202** Integration System for Linguistic Software and Data Set: uLAMP (Unified Linguistic Asset Management Platform)  
Jung-Ho Um, Sung-Ho Shin, Sung-Pil Choi, Seungwoo Lee, and Hanmin Jung
- SA2204** Scalable Visualization of DBpedia Ontology Using Hadoop  
Sung-min Kim, Seonug-hun Park, and Young-guk Ha
- SA2205** Content and Expert Recommendation System Using Improved Collaborative Filtering Method for Social Learning  
Jinwoo Park, Kyounguk Lee, and Kyungsun Kim

## ***Special Session on Technologies and Theories of Narrative***

Session Chair: Takashi Ogata

Session Time: 4:00pm-6:00pm

Location: **Room F** (9F ASAMA)

- SA6201** Nostalgia Based Narrative Rhetoric Generation for Film  
Akihito Kanai
- SA6202** Narrative Generation by Advertising Communication Strategy  
Yoji Kawamura
- SA6203** Automatic Animation Composition System for Event Representation  
Yusuke Manabe, Takanori Ohsugi, and Kenji Sugawara
- SA6204** Narrative on the Road  
Hitoshi Morita
- SA6206** Methods for Generalizing the Propp-Based Story Generation Mechanism  
Shohei Imabuchi and Takashi Ogata
- SA6207** A Framework of Narrative Knowledge Acquisition Based on Inter-Textuality  
Jumpei Ono and Takashi Ogata

## ***Wednesday, October 30, 2013***

### ***Special Session on Evolutionary Computation and its Application***

Session Chair: Kenichi Ida

Session Time: 9:00am-11:00am

Location: **Room D** (9F TSUTSUJI-1)

- SA7201** GA-Based Method for Optimal Weight Design Problem of 23 Stories Frame Structure  
Takao Yokota, Kiyoshi Tsukagoshi, Shozo Wada, Takeaki Taguchi, and C. Tarn
- SA7202** A Proposal of a Genetic Algorithm for Bicriteria Fixed Charge Transportation Problem  
Toshiki Shizuka and Kenichi Ida
- SA7203** The GMM Problem as One of the Estimation Methods of a Probability Density Function  
Kiyoshi Tsukagoshi, Kenichi Ida, and Takao Yokota
- SA7204** GA for JSP with Delivery Time  
Yusuke Kikuchi, Kenichi Ida, and Mitsuo Gen
- SA7205** Advances in Multiobjective Hybrid Genetic Algorithms for Intelligent Manufacturing and Logistics Systems  
Mitsuo Gen and Kenichi Ida

### ***Special Session on Intelligent Media Search Techniques***

Session Chair: Zhiguo Gong

Session Time: 11:00am-1:00pm

Location: **Room D** (9F TSUTSUJI-1)

- SA8201** A Semantic Coherence Based Intelligent Search System  
Weidong Liu and Xiangfeng Luo
- SA8202** Pyxis+: A Scalable and Adaptive Data Replication Framework  
Yuwei Yang, Beihong Jin, and Sen Li
- SA8203** Classifying Mass Spectral Data Using SVM and Wavelet-Based Feature Extraction  
Liyen Wong, Maybin Muyebe, John Keane, Zhiguo Gong, and Valerie Edward-Jones
- SA8204** Multi-Scale Local Spatial Binary Patterns for Content-Based Image Retrieval  
Yu Xia, Shouhong Wan, Peiquan Jin, and Lihua Yue

# AMT 2013 Type II Program

*Thursday, October 31, 2013*

## *AMT Based Support Systems and Technologies*

Session Chairs: Takeshi Matsuda and Niran Chawla

Session Time: 1:30pm-3:30pm

Location: **Room F** (9F ASAMA)

- A230** Learning Support System Based on Stochastic Model and Real Data of Users  
Takeshi Matsuda
- A258** A Support System for Selecting BGM of a Video Based on Impression Estimation  
Kiyoshi Tokunaga and Takahiro Hayashi
- A265** Fingernail Detection System Allowing Existence of Palm Area  
Noriaki Fujishima and Kiyoshi Hoshino
- A268** An Emerging of Active Media Technology in Hotel e-Service Management  
Niran Chawla and Montri Wiboonrat

## *Information Retrieval and Data Mining*

Session Chairs: Nittaya Kerdprasop and Gang Kou

Session Time: 1:30pm-3:30pm

Location: **Room I** (9F MYOGI)

- A259** Video Scene Search Based on Emotion Tags  
Yuhei Yamaguchi and Takahiro Hayashi
- A262** Quantification of the Sound Quality of a Ukulele Based on the Semantic Differential Method  
Atsushi Kajihara, Masaki Shiga, Tetsumi Harakawa, and Shigeru Osawa
- A263** Query Formulation and Evaluation for Top-k Frequent Pattern Mining  
Nittaya Kerdprasop and Kittisak Kerdprasop
- A264** Fast Vector Image Retrieval System with Indirect Similarity Evaluation Approach  
Akihiko Sato and Takahiro Hayashi
- A270** Estimating Missing Judgments in the Pairwise Comparison Matrices  
Daji Ergu and Gang Kou

# BHI 2013 Type I Program

*Tuesday, October 29, 2013*

## *Thinking and Perception-Centric Investigations of Human Information Processing System I*

Session Chairs: Yan Li and Kensuke Nakamura

Session Time: 2:00pm-4:00pm

Location: **Room G** (9F AKAGI)

- B202** The Role of Correlated Inhibitory Cell Firing  
Ichiro Sakurai, Shigeru Kubota, and Michio Niwano
- B204** Effects of Virtual Training on Emotional Response: A Comparison between Different Emotion Regulation Strategies  
Tibor Bosse, Charlotte Gerritsen, Jeroen de Man, and Jan Treur
- B215** Role of the Prefrontal Cortex (PFC) on Processing the Social Statistical Information: An fMRI Study  
Mi Li, Haiping Wei, Yu Zhou, Pengfei Liu, Xingyu Su, Shengfu Lu, and Ning Zhong
- B221** Effects of Category Labels on P300 in Facial Recognition  
Pengfei Yan, Yoshiko Yabe, and Hiroaki Shigemasa

## *Information Technologies for Curating, Mining, Managing and Using Big Brain/Health Data*

Session Chairs: Yike Guo and Yukio Ohsawa

Session Time: 4:00pm-6:00pm

Location: **Room G** (9F AKAGI)

- B225** Extraction Algorithm of Similar Parts from Multiple Time-Series Data of Cerebral Blood Flow  
Tomoyuki Hiroyasu, Arika Fukushima, and Utako Yamamoto
- B206** An Approximation Approach to Measurement Design in the Reconstruction of Functional MRI Sequences  
Shulin Yan, Lei Nie, Chao Wu, and Yike Guo
- B219** Composite Kernels for Automatic Relevance Determination in Computerized Diagnosis of Alzheimer's Disease  
Murat Seckin Ayhan, Ryan G. Benton, Vijay V. Raghavan, and Suresh Choubey
- B242** Unsupervised Classification of Epileptic EEG Signals with Multi Scale K-Means Algorithm  
Guohun Zhu, Yan Li, Peng (Paul) Wen, Shuaifang Wang, and Ning Zhong

## ***Wednesday, October 30, 2013***

### ***Thinking and Perception-Centric Investigations of Human Information Processing System II***

Session Chairs: D. Frank Hsu and Haiyan Zhou

Session Time: 9:00am-11:00am

Location: **Room G** (9F AKAGI)

- B226** Analysis of Brain Areas Activated While Using Strategies to Improve the Working Memory Capacity  
Tomoyuki Hiroyasu, Shogo Obuchi, Misato Tanaka, and Utako Yamamoto
- B229** Neural Mechanism of Mental Imagery in Problem Solving  
Xiangsheng Shen, Haiyan Zhou, Fenfen Wang, Zhoujun Long, Jun Zhou, Chuan Li, Yulin Qin, Kuncheng Li, and Ning Zhong
- B230** The Change of Resting EEG in Depressive Disorders  
Zhizhou Liao, Haiyan Zhou, Chuan Li, Jun Zhou, Yulin Qin, Yuan Feng, Lei Feng, Gang Wang, and Ning Zhong
- B236** Combining Two Visual Cognition Systems Using Confidence Radius and Combinatorial Fusion  
Amy Batallones, Kilby Sanchez, Brian Mott, Cameron McMunn-Coffran, and D. Frank Hsu

### ***Information Technologies for Healthcare I***

Session Chairs: Masato Odagaki and Yasuyuki Ishikawa

Session Time: 9:00am-11:00am

Location: **Room H** (9F HARUNA)

- B207** Argumentation Theory for Decision Support in Health-Care: A Comparison with Machine Learning  
Luca Longo and Lucy Hederman
- B217** Evaluating Functional Ability of Upper Limbs after Stroke Using Video Game Data  
J.Q. Shi, Y. Cheng, J. Serradilla, G. Morgan, C. Lambden, G.A. Ford, C. Price, H. Rodgers, T. Cassidy, L. Rochester, and J.A. Eyre
- B220** Optimization of Eddy Current Distribution Using Magnetic Substance in TMS  
Masato Odagaki, Toshiyuki Taura, Yutaka Kikuchi, and Kazutomo Yunokuchi
- B244** Telemedicine and Telemonitoring in Healthcare  
Salmah F.A. Alsgaer, Xiaohui Tao, Ji Zhang, Hua Wang, and Zhi Guo

***Data Analytics, Data Mining, and Machine Learning***

Session Chairs: Shusaku Tsumoto and Tom Johnsten

Session Time: 9:00am-11:00am

Location: **Room I** (9F MYOGI)

- B222** What We Found on Our Way to Building a Classifier: A Critical Analysis of the AHA Screening Questionnaire  
Quazi Abidur Rahman, Sivajothi Kanagalingam, Aurelio Pinheiro, Theodore Abraham, and Hagit Shatkay
- B223** Mining Clinical Pathway Based on Clustering and Feature Selection  
Haruko Iwata, Shoji Hirano, and Shusaku Tsumoto
- B209** Bayesian Network Based Heuristic for Energy Aware EEG Signal Classification  
Abduljalil Mohamed, Khaled Bashir Shaban, and Amr Mohamed
- B232** Diagnosis and Grading of Alzheimer's Disease via Automatic Classification of FDG-PET Scans  
Ryan G. Benton, Suresh Choubey, David G. Clark, Tom Johnsten, and Vijay V. Raghavan

***Thinking and Perception-Centric Investigations of Human Information Processing System III***

Session Chairs: Azizi Ab Aziz and Jianhui Chen

Session Time: 11:00am-1:00pm

Location: **Room G** (9F AKAGI)

- B228** Common and Dissociable Neural Substrates for 2-Digit Simple Addition and Subtraction  
Yang Yang, Ning Zhong, Kazuyuki Imamura, and Xiuya Lei
- B237** Sex Differences in the Human Connectome  
Vivek Kulkarni, Jagat Sastry Pudipeddi, Leman Akoglu, Joshua T. Vogelstein, R. Jacob Vogelstein, Sephira Ryman, and Rex E. Jung
- B241** A Multi-Agent Model for Supporting Exchange Dynamics in Social Support Networks during Stress  
Azizi Ab Aziz and Faudziah Ahmad
- B243** An Attention Level Monitoring and Alarming System for the Driver Fatigue in the Pervasive Environment  
Zhijiang Wan, Jian He, and Alicia Voisine

### ***Information Technologies for Healthcare II***

Session Chairs: Shao Ying Zhu and Hiroki Matsumoto

Session Time: 11:00am-1:00pm

Location: **Room H** (9F HARUNA)

- B212** Detrended Fluctuation Analysis of Photoplethysmography in Diabetic Nephropathy Patients on Hemodialysis  
Yoshihiro Tsuji, Tetsuya Asakawa, Yasumasa Hitomi, Atsu Todo, Toshiko Yoshida, and Yuko Mizuno-Matsumoto
- B231** Breast Cancer Identification Based on Thermal Analysis and a Clustering and Selection Classification Ensemble  
Bartosz Krawczyk, Gerald Schaefer, and Shao Ying Zhu
- B239** Peculiarity Oriented EEG Data Stream Mining  
Shinichi Motomura, Muneaki Ohshima, and Ning Zhong
- B224** Bottom Up Approach and Devolved Design of a Health Information System: eHealth TABLET  
Ma. Regina Estuar, Dennis Batangan, Andrei Coronel, Anna Christine Amarra, and Francisco Castro

## ***Thursday, October 31, 2013***

### ***Applications in BHI***

Session Chairs: Ichiro Fukumoto and Bin Hu

Session Time: 1:30pm-3:30pm

Location: **Room E** (9F TSUTSUJI-2)

- B201** Physiological Diagnosis and Rehabilitation for the Alzheimer Type Dementia  
Ichiro Fukumoto
- B211** Development of a Wide-View Visual Presentation System for Functional MRI Studies of Peripheral Visual  
Bin Wang, Jinglong Wu, JiaJia Yang, Yuu Hikino, Satoshi Takahashi, Tianyi Yan, Seiichiro Ohno, and Susumu Kanazawa
- B218** PolyMorph: A P300 Polymorphic Speller  
Alberto Casagrande, Joanna Jarmolowska, Marcello Turconi, Francesco Fabris, and Piero Paolo Battaglini
- B227** Health Condition Alarm System  
Maiga Chang, Ebenezer Aggrey, Mehadi Sayed, and Kinshuk
- B208** Fuzzy Linguistic Preference Relations Approach: Evaluation in Quality of Healthcare  
Pei-Jung Yang and Tsung-Han Chang

# BHI 2013 Workshops/Special Sessions

*Tuesday, October 29, 2013*

## *Special Session on Cutting Edge Research of Neuroinformatics in the Clinical Research*

Session Chairs: Shiro Usui and Yoko Yamaguchi

Session Time: 2:00pm-4:00pm

Location: **Room B** (8F KEYAKI)

- SBA201** Japan's Neuroinformatics for Collaborative Research - An Approach at INCF Japan Node  
Yoko Yamaguchi and Shiro Usui
- SBA202** Inter-Brain Synchronization for Human-Human Communication: Elucidation in Autism Spectrum Disorders  
Masahiro Kawasaki, Yasuko Funabiki, Keiichi Kitajo, Kenjiro Fukao, Toshiya Murai and Yoko Yamaguchi
- SBA204** Dissociation of Predictive and Feedback Controllers and Its Application for Evaluation of Motor Functions in Cerebellar Disorders  
Shinji Kakei
- SBA205** Neuroimaging Platform and Its Application to Clinical and Industrial Use  
Shinobu Masaki
- SBA203** International Neuroinformatics Coordinating Facility: Establishing Standards and Infrastructure for Large Scale Brain Initiatives  
Jan G. Bjaalie

## *Workshop on Granular Knowledge Discovery in Biomedical & Active-Media Environments*

Session Chairs: Andrzej Skowron, Dominik Ślęzak, Shusaku Tsumoto, and Yiyu Yao

Session Time: 2:00pm-4:00pm

Location: **Room E** (9F TSUTSUJI-2)

- SB2201** Strategies for Creative Argumentation: Learned from Logs of Innovators Market Game  
Yukio Ohsawa, Hiroyuki Kido, Teruaki Hayashi, Masahiro Akimoto, Masanori Fujimoto, and Masaki Tamada
- SB2202** On a Possibility of Applying Interrelationship Mining to Gene Expression Data Analysis  
Yasuo Kudo, Yoshifumi Okada, and Tetsuya Murai
- SB2203** How to Design a Network of Comparators  
Lukasz Sosnowski and Dominik Slezak



**SB2204** Algorithmic Granularity with Constraints  
Roussanka Loukanova

**SB2206** Incremental Induction of Medical Diagnostic Rules Based on Incremental Sampling Scheme and Rule Layers  
Shusaku Tsumoto and Shoji Hirano

### ***Workshop on Mental Healthcare with ICT***

Session Chairs: Bin Hu, Xiaowei Li and Philip Moore

Session Time: 4:00pm-6:00pm

Location: **Room E** (9F TSUTSUJI-2)

**SB1201** A Humanoid Robot Used as an Assistive Intervention Tool for Children with Autism Spectrum Disorder: A Preliminary Research  
Mingqi Zhao, Qinglin Zhao, Quanying Liu, Na Li, Hong Peng, and Bin Hu

**SB1202** Web Use Behaviors for Identifying Mental Health Status  
Ang Li, Fan Zhang, and Tingshao Zhu

**SB1203** Developing Simplified Chinese Psychological Linguistic Analysis Dictionary for Microblog  
Rui Gao, Bibo Hao, He Li, Yusong Gao, and Tingshao Zhu

## ***Wednesday, October 30, 2013***

### ***Special Session on Human Centered Computing***

Session Chairs: Jiannong Cao and Yan Liu

Session Time: 9:00am-11:00am

Location: **Room E** (9F TSUTSUJI-2)

**SB5201** Selecting Suitable Image Retargeting Methods with Multi-Instance Multi-Label Learning  
Muyang Song, Tongwei Ren, Yan Liu, Jia Bei, and Zhihong Zhao

**SB5202** Towards Thought Control of Next-Generation Wearable Computing Devices  
Courtney Powell, Masaharu Munetomo, Martin Schlueter, and Masataka Mizukoshi

**SB5203** Developing a Brain Informatics Provenance Mode  
Han Zhong, Jianhui Chen, Taihei Kotake, Jian Han, Ning Zhong, and Zhisheng Huang

**SB5204** Communication Board for Disabilities in HTML5  
Tsz Wa Ho, Ho Wang Lam, and King Hong Cheung

***Special Session on Neuro-Robotics***

Session Chair: Chi Zhu

Session Time: 9:00am-11:00am

Location: **Room F** (9F ASAMA)

- SB6202** Analysis of the Relationship between Load and EEG by Wavelet Transform for BMI  
Kazuhiro Uemoto, Masataka Yoshioka, Yuichiro Yoshikawa, and Chi Zhu
- SB6203** Multi-Command Chest Tactile Brain Computer Interface for Small Vehicle Robot  
Navigation  
Hiromu Mori, Shoji Makino, and Tomasz Rutkowski
- SB6204** Optimizing the Individual Differences of EEG Signals through BP Neural Network  
Algorithm for a BCI Dialing System  
Dongxue Lin, Feng Duan, Wenyu Li, and Jingyao Shen
- SB6205** An Examination of Gender Differences in mu Rhythm of the Mirror-Neuron System  
during the Imagination of Observed Action  
Sakiko Ogoshi, Yasuhiro Ogoshi, Tomohiro Takezawa, and Yoshinori Mitsuhasi

***Special Session on Intelligent Healthcare Data Analytics***

Session Chair: Yiu-ming Cheung

Session Time: 11:00am-1:00pm

Location: **Room E** (9F TSUTSUJI-2)

- SB8201** Feature Weighted Kernel Clustering with Application to Medical Data Analysis  
Hong Jia and Yiu-ming Cheung
- SB8202** Knowledge Extraction and Mining in Biomedical Research Using Rule Network Model  
Sheung Wai Chan, Ho Cheung Leung, and Alfredo Milani
- SB8203** Online Learning Towards Big Data Analysis in Health Informatics  
Jing Wang, Zhong-Qiu Zhao, Xuegang Hu, Yiu-ming Cheung, Haibo Hu, and Fangqing Gu
- SB8204** A Complex Systems Approach to Infectious Disease Surveillance and Response  
Benyun Shi, Shang Xia, and Jiming Liu

***Workshop on Biological Database Analysis for Health Science***

Session Chairs: Kensuke Nakamura and Shigehiko Kanaya

Session Time: 11:00am-1:00pm

Location: **Room F** (9F ASAMA)

- SB3201** Evaluation of Parameters Estimation with Multiple Echo and Simulation Accuracy of  
Signal Intensity for Educational MRI Simulator  
Tetsuo Sato, Kenta Hori, and Tomohisa Okada

- SB3202** The Medicinal Plant Information Retrieval from KNApSAcK Family Databases Is Helpful for Health Related Studies  
Yukiko Nakamura, Tsuyoshi Shirai, Yuki Otana, Farit Mochamad Afendi, Aziza Kawsar Parvin, Tetsuo Katsuragi, Shun Ikeda, Naoaki Ono, Kensuke Nakamura, Ken Tanaka, Aki Hirai Morita, Md. Altaf-Ul-Amin, and Shigehiko Kanaya
- SB3203** Analysis of Next Generation Sequencer Data  
Kensuke Nakamura
- SB3204** Integrating Biochemical and Physical Attributes of Amino Acids in Protein Sequence Analyses  
Nelson Kibinge, Shun Ikeda, Naoaki Ono, Md. Altaf-Ul-Amin, and Shigehiko Kanaya
- SB3205** The Significances and Realizability of a Personal Database for Heart Rate  
Ming Huang
- SB3206** RNA-Seq Analysis of Curcuminoid Synthesis Pathway of Curcumin Longa  
Donghan Li, Naoaki Ono, Shigehiko Kanaya, and Ken Tanaka
- SB3207** REST-ful Approach for Data-Distributed Community-Web Service  
Masanori Arita and Ramon Mejia

***Special Session on Monitoring and Control of Biosignaling  
-Roles of Proteolysis for Biosignaling during Cognitive Behavior***

Session Chairs: Sadao Shiosaka and Yasuyuki Ishikawa

Session Time: 11:00am-1:00pm

Location: **Room I** (9F MYOGI)

- SB7201** Role of Synaptic Serine Protease Neuropsin as a Modulator of Neural Plasticity  
Yasuyuki Ishikawa
- SB7202** A Serine Protease in the Brain Modulates Social Behaviors.  
Shinichi Mitsui
- SB7203** CMOS-Based Implantable Brain Imaging Technology  
Takashi Tokuda, Makito Haruta, Yasumi Ohta, Mayumi Motoyama, Toshihiko Noda, Kiyotaka Sasagawa, Yasuyuki Ishikawa, Sadao Shiosaka, and Jun Ohta

# BHI 2013 Invited Special Sessions

*Thursday, October 31, 2013*

## *Solving the Mystery of Sleep*

Session Chairs: Masashi Yanagisawa and Yoshihiro Urade

Session Time: 1:30pm-3:30pm

Location: **Room B** (8F KEYAKI)

- SB9201** Humoral Regulation of Sleep by Prostaglandin D2 and Adenosine  
Yoshihiro Urade
- SB9202** Distinct and Overlapping Roles of Two Orexin Receptors in Sleep/Wake Regulation  
Takeshi Sakurai
- SB9203** Why Coffee Wakes Us up? – The Role of Adenosine A2A Receptors in Sleep-Wake  
Regulation  
Michael Lazarus
- SB9204** Forward Genetic Analysis of Sleep in ENU-Mutagenized Mice  
Masashi Yanagisawa
- SB9205** FASTER: An Unsupervised Fully Automated Sleep Staging Method for Mice.  
Genshiro A. Sunagawa

## *Heavy Ion Irradiation Therapy:*

### *Synergy of Medical and Engineering Sciences*

Session Chairs: Takashi Nakano and Tomoaki Shirao

Session Time: 1:30pm-3:30pm

Location: **Room D** (9F TSUTSUJI-1)

- HI1. Heavy Ion Therapy for Cancer Patients in Japan  
Takashi Nakano
- HI2. Recent Progress and Future Plans for the Heavy Ion Medical Accelerator in Chiba (HIMAC)  
Koji Noda
- HI3. Carbon Beam Microsurgery and Medical Compton Camera for Next Generation Brain Surgery  
Kota Torikai, Yoshiyuki Suzuki, Kazuo Arakawa, Shin'ei Noda, Makoto Sakai, Mutsumi Tashiro,  
Hirofumi Shimada, Yukari Yoshida, Yoshiki Kubota, Akihiko Matsumura, Akito Saito,  
Tatsuaki Kanai, Satoru Yamada, Mitsutaka Yamaguchi, Yuuto Nagao, Naoki Kawachi,  
Tomihiko Kamiya, Tadayuki Takahashi, Shin'ichiro Takeda, Shin Watanabe and Takashi Nakano
- HI4. Radiation Induced Change in the Neuronal Cytoskeleton and Its Possible Adverse Effect on  
Brain Function  
Tomoaki Shirao, Noriko Koganezawa, Anggraeni Puspitasari, Yoshiyuki Suzuki, Natsume Tanaka,  
Sachiko Tanaami, Takashi Nakano and Nobuhiko Kojima

## BHI 2013 Type II Program

*Tuesday, October 29, 2013*

### *Information Technologies for Curating, Mining, Managing and Processing Big Brain/Health Data*

Session Chairs: Abdulkadir Sengur and Tomoyuki Hiroyasu

Session Time: 2:00pm-4:00pm

Location: **Room H** (9F HARUNA)

- B247** Iterative Hard Thresholding Based Extreme Learning Machine and Its Application to Predictions in Medical Datasets  
Omer F. Alcin, Abdulkadir Sengur, and Melih C. Ince
- B261** Attenuation of Cortical Coherence Shared by Anesthetic-Induced Unconsciousness and Alzheimer's Disease  
Yuri Watanabe, Jiro Kurata, Shuo Zhang, Yohei Kobayashi, Toshimitsu Musha, and Yukio Kosugi
- B274** Constructing the Brain Data Center for Brain Big Data: An Innovative Method for Storing Actual Brain Data  
Taihei Kotake, Ning Zhong, Jianhui Chen, Zhisheng Huang, Han Zhong, and Jian Han

### *Healthcare Decision Support*

Session Chairs: Katsumi Sakata and Yasutomo Nomura

Session Time: 2:00pm-4:00pm

Location: **Room I** (9F MYOGI)

- B251** A Characteristic Structure in Metabolic Network Induces Self-Organization Responding to Flooding Stress in Soybean  
Katsumi Sakata, Hamid Rashid, Ramesh Katam, Kentaro Ishige, Shuhei Horio, Hajime Ohyanagi, and Setsuko Komatsu
- B259** Detection of Glycated Hemoglobin Using Fluorescence Correlation Spectroscopy  
Yasutomo Nomura and Kyohei Nakayama
- B272** PRECO: A Predictive Framework for Comorbidities Prediction  
Mehdi Snene and Manel Sghir
- B279** Weighted Naïve Bayesian Classifier for Breast Cancer Detection  
Murat Karabatak
- B280** Maximum Margin Clustering for Medical Data Classification  
Sami Ekici and Abdulkadir Sengur

***Thinking and Perception-Centric Investigations of Human Information Processing System I***

Session Chairs: Tomoaki Shirao and Chi Zhu

Session Time: 4:00pm-6:00pm

Location: **Room H** (9F HARUNA)

- B234** Segmentation of MS Lesions in MR Images 3D  
Nacéra Benamrane, Amina Merzoug, and Taleb-Ahmed Adbelmalik
- B254** The Role of the Frontal Cortex in Granular Hierarchical Processing  
Xiuuzhen Wang and Weiquan Gu
- B255** fNIRS Analysis during a Stroop Test in Different Languages, Activated Areas and Link between Language Proficiency, Stroop Results and Brain Activation  
Blandine Landrieu, Utako Yamamoto, and Tomoyuki Hiroyasu
- B258** The Effect of the Pleasantness Level of Pictures upon Cerebral Activity Using fMRI  
Utako Yamamoto, Ayumi Omura, Misato Tanaka, and Tomoyuki Hiroyasu
- B265** Impairment of Adult Neurogenesis by Drebrin Knockout Results in the Olfactory Dysfunction  
Yuki Kajita, Nobuhiko Kojima, Kenji Sakimura, and Tomoaki Shirao
- B273** Modeling the Cognitive Processing during 2-Digit Addition and Subtraction Based on ACT-R Simulating  
Yushu Guo and Ning Zhong

***Applications in BHI***

Session Chairs: Feng Wang and Bradley Chase

Session Time: 4:00pm-6:00pm

Location: **Room I** (9F MYOGI)

- B249** EEG and Eye Tracking for Monitoring Operator Cognitive State  
Bradley Chase
- B260** A Comparative Study of ASSR Classification Problem Using Bipolar and Monopolar EEG Voltages  
Fumi Fukaya, Takashi Nakamura, Hironao Namba, and Takashi Matsumoto
- B277** A Brain Inspired Model for Multimodal Data Mining in Healthcare  
Yee Ling Boo and Bob Li
- B281** Real-Time Detection of Respiration and Heartbeat during Sleep Using PVDF Sensors and ICA Algorithm  
Keisuke Kuboyama and Feng Wang

## ***Thursday, October 31, 2013***

### ***Thinking and Perception-centric Investigations of Human Information Processing System II***

Session Chairs: Masayuki Kobayashi and Noriko Koganezawa

Session Time: 1:30pm-3:30pm

Location: **Room G** (9F AKAGI)

- B245** Time-Dependent Effect of X-Irradiation on Fear Conditioning and Synaptic Protein  
Noriko Koganezawa, Anggraeni Puspitasari, Natsume Tanaka, Sachiko Tanaami,  
Nobuhiko Kojima, and Tomoaki Shirao
- B266** Effects of Histone Deacetyltransferase Inhibitor and Allopregnanolone on Neuron and Synapses:  
New Analyzing System of Neuronal and Synaptic Function Using Drebrin as a Functional Marker  
Hideo Shimizu, Yuta Ishizuka, Eiko Takagi, Reiko T. Roppongi, and Tomoaki Shirao
- B269** Spatial Profile of Neural Excitation in Rat Insular Cortex Evoked by Electrical Stimulation  
of Mandibular and Maxillary Molar Tooth Pulp: An Optical Imaging Study  
Masayuki Kobayashi and Risako Kato
- B270** Enhanced Spatial Cognitive Learning by the Exposure to Low-Frequency Magnetic Field in Mice  
Takahiro Yoshihara, Hiroki Matsubayashi, and Kazuyuki Imamura
- B271** MRI-Based Localization of Electrophysiological Recording Sites in the Primate Cerebral  
Cortex  
Masaki Takeda, Kenji W Koyano, Akinori Machino, Teppei Matsui, Ryoko Fujimichi,  
Yohei Ohashi, and Yasushi Miyashita
- B278** Regulation of Various Cellular Functions by Low-Reactive Level Near-Infrared Laser Irradiation  
Masanori Yamato, Yasuhisa Tamura, Katuhiro Maki, Hiroshi Riquimaroux,  
and Yosky Kataoka

### ***Information Technologies for Healthcare Delivery and Management***

Session Chairs: Kittisak Kerdprasop and Yan Li

Session Time: 1:30pm-3:30pm

Location: **Room H** (9F HARUNA)

- B253** A Knowledge Engineering Approach to the Recognition of Genomic Coding Regions  
Kittisak Kerdprasop and Nittaya Kerdprasop
- B257** Personalization Approach in Health Information Retrieval System  
Ira Puspitasari, Ken-ichi Fukui, Koichi Moriyama, and Masayuki Numao
- B268** Analyzing "Meningitis" Mentions on Twitter  
Herchel Thaddeus Machacon
- B276** Metabolic Biomarkers of Fatigue in a Rat Model Using Multivariate Analysis  
Satoshi Kume, Masanori Yamato, Guanghua Jin, Yukiharu Miyashige, Masayuki Nakano,  
Yasuhisa Tamura, Tomoyoshi Soga, and Yosky Kataoka
- B252** Brain Wave Analysis under Aromatherapy  
Kang-Ming Chang, Chiung-Ju Chien, and Sih-Huei Chen

# Keynote Abstracts

## *Special AMT-BHI Joint Keynote Lecture*

Chaired by Prof. Kazuyuki Imamura

(2:00p.m.-3:00p.m., October 30, 2013)



Yuichiro Anzai

President, Japan Society for  
the Promotion of Science, Japan

## *Human-Robot Interaction: Our Experience Since 1991*

### **Abstract**

AMT (Active Media Technology) and Brain and Health Informatics (BHI) are both growing and enlarging arenas that attract people interested in a variety of fields from sciences to engineering, and to our quality of lives and society. Even there are lots of enchanting topics at the intersection of AMT and BHI, notably including R&D towards smooth and comfortable interaction between humans and their environments. In the main course of this talk, I will compile, as an example from such enchanting topics, our long-standing effort since 1991 towards new ways of exploring human-robot interaction. It contains basic technologies, design implications given from cognitive sciences, and possible application to the improvement of the quality of our lives. In the talk I will spare a little bit of time to touch upon the current and possible future trends of science, technology and innovation policies in Japan, particularly those related to AMT and BHI, that may help develop birds-eye views of our dynamically moving fields.

### **Speaker Biography**

Yuichiro Anzai, while receiving M.S. in 1971 and Ph.D. in 1974 both from Keio University, started research on human cognitive processes and machine learning in mid 1970's, and spent 1976-78 and 1981-82 at Carnegie-Mellon University as post-doc and visiting assistant professor, respectively. After coming back to his country, he became associate professor in psychology at Hokkaido University (1985-88), and professor in computer science at Keio University (1988). He was also visiting professor at McGill University (1990). Up to the present he has kept working on human learning and problem solving processes, while doing extensive research on human-robot interaction that he started in 1991 with his students. He published numerous academic articles and books, including *Pattern Recognition and Machine Learning*, *Concepts and Characteristics of Knowledge-based Systems* (co-ed) and *Symbiosis of Human and Artifact Vols. 1 and 2* (co-ed), all written in English, and *Mind and Brain: Introduction to Cognitive Science and The Psychology of Problem Solving: Ideas towards the Age of Human Beings*, both in Japanese.

He spent eight years as Dean of Faculty of Science and Technology, Keio University (1993-2001), then eight more years as President of the same university (2001-09). In October 2011 he became President, Japan Society for the Promotion of Science, the representative governmental research funding agency that supports basic research in all the academic fields, as well as a large number of post-docs and doctoral students, and a variety of international academic collaborations.

Anzai is currently chairing University Subcouncil of the Central Council for Education and Council for the Innovation of Learning, and also working as a member of the Council for Science and Technology and its Brain Science Committee. His past public contribution includes Chairperson of Association of Pacific Rim Universities (2008-09), Member of the Science Council of Japan (2005-11), and President of the Information Processing Society of Japan (2005-07) and Japanese Cognitive Science Society (1993-94).



### ***BHI Special Keynote Lecture***

*Chaired by Prof. Takuji Kasamatsu*

*(9:30a.m.-10:30a.m., October 29, 2013)*



Shinsuke Shimojo

Professor at California Institute of Technology, USA

### ***Sensory Substitution, Multisensory Plasticity, and the Third Kind of "Qualia"***

#### **Abstract**

“Qualia” to some refers to the absolute, unique quality of a conscious sensory experience, which may not be “explained away” by neurophysiology. Whereas we do not endorse to the qualia as a “hard” (i.e. impossible in principle) problem for science, we still agree that the current sensory sciences fail to critically characterize such unique quality of sensory experiences.

We aim to find insights in the latest progresses of sensory substitution. The “vOICe” is one of such devices translating visual into auditory inputs for blind people. There are some superusers who claim “visual” experiences. Moreover, some of them showed neural activity in the visual cortical areas in fMRI, when engaged in a variety of tasks relying on this type of device.

Our strategy is to come up with a brief list of psychophysical and neuroscientific criteria for “vision-like” processing, and to search for empirical evidence, including (1) cortical mapping of space via the device, (2) accomplishment of perceptual constancy, and (3) intrinsic (synesthesia-like) crossmodal mapping. Another approach we take is to fully utilize intrinsic crossmodal mappings (correspondences) to make the training and perception via the device automatic and effortless.

The results suggest that qualia, if still want to use such a word, should be understood with regard to adaptive behavior and automatic processing. Moreover, what such training/experience accomplishes should be characterized best as the third kind of qualia. Enrichment of sensory experiences due to intrinsic and associative mapping provides scientists, engineers and artists with ample opportunities.

#### **Speaker Biography**

Shinsuke Shimojo is an experimental psychologist/cognitive neuroscientist, with long-standing interests in visual psychophysics and their applications to visual illusions, cross-modal plasticity, human emotion, preferences, and decision making. He received his BA and MA degrees from the University of Tokyo ('78, '80), and Ph.D. from Massachusetts Institute of Technology ('85). He is currently Gertrude Baltimore Professor in Experimental Psychology in Division of Biology/Computation and Neural Systems at California Institute of Technology (Caltech). His laboratory at Caltech has been applying quantitative psychophysical techniques to understand human implicit perception and social behaviors, with applications of eye tracking, fMRI, EEG, TMS and tDCS, and other techniques. He has approximately 150 publications, including multiple papers in high-impact journals, such as Nature, Science, Nature Neuroscience, and Neuron. He has received multiple awards including the Tokizane memorial award from the Japanese Society of Neuroscience. He is also known for his installations at science museums (both in the US and Japan), his collaborations with artists, and essays in a newspaper science column (ASAHI WEBRONZA).

***AMT Keynote Lecture****Chaired by Prof. Ning Zhong**(10:50a.m.-11:50a.m., October 29, 2013)*

Carl K. Chang

Professor at Iowa State University, USA

***Situational Software Engineering*****Abstract**

In this talk I will review and discuss past and present software engineering research and practices based on a “situational” perspective. Then, I will speculate on a possible roadmap that may lead software engineering as a discipline into a brave new world of computing. It is my intention through this talk to impress upon the audience the importance of the fast emerging situational computing as the new platform to advance software engineering. Computer systems must be able to adapt to the dynamic and changing environment in response to instant or delayed feedback from a service installation that nowadays is becoming more and more context aware. However, current context-aware service-centric models largely lack the capability to continuously explore human mental states that are hidden, yet often drive system evolution. This talk presents my current research in Situi. In this study, I give situation a definition that is rich in semantics and useful for modeling and reasoning about human intentions, whereas the definition of intention hinges upon reading a temporal sequence of situations to reach a goal. Based on this framework, instant definition of individualized service requirements at runtime may become possible, and it may significantly shorten the service evolution cycle. In the end, I will enumerate steep research challenges in order to accomplish what I envisioned.

**Speaker Biography**

Carl K. Chang is Professor of the Department of Computer Science at Iowa State University. He received a PhD in computer science from Northwestern University in 1982, and worked for GTE Automatic Electric and Bell Laboratories before joining the University of Illinois at Chicago in 1984. He joined Iowa State University in 2002 as department chair of computer science. His research interests include requirements engineering, net-centric computing, situational software engineering and successful aging. Chang is 2004 President of IEEE Computer Society. Previously he served as the Editor-in-Chief for IEEE Software (1991-94). He received the Computer Society’s Meritorious Service Award, Outstanding Contribution Award, the Golden Core recognition, and the IEEE Third Millennium Medal. In 2006 he received the prestigious Marin Drinov Medal from the Bulgarian Academy of Sciences, and was recognized by IBM with the IBM Faculty Award in 2006, 2007 and 2009. From 2007-2010 he served the Editor-in-Chief of IEEE Computer, the flagship publication of IEEE Computer Society. He is the 2012 recipient of the Richard E. Merwin Medal from the IEEE Computer Society. Chang is an IEEE and AAAS Fellow, and member of the European Academy of Sciences.

## ***AMT Keynote Lecture***

*Chaired by Prof. Tetsuya Yoshida*

*(11:50a.m.-12:50p.m., October 29, 2013)*



Andrzej Skowron

Professor at University of Warsaw, Poland

## ***Interactive Rough-Granular Computing in Wisdom Technology***

### **Abstract**

We discuss the Wisdom Technology approach based on a meta-equation

$$\text{wisdom} = \text{interactions} + \text{adaptive judgment} + \text{knowledge bases.}$$

Understanding of interactions is the critical issue of complex systems. Interactions in physical world are represented by information granules. Interactive computations are modeled using the interactive granular computing approach based on the rough set methods in combination with other soft computing approaches. Adaptive judgment allows us to reason about information granules and interactive computations performed on them. In adaptive judgment, different kinds of reasoning are involved such as deduction, induction, abduction or reasoning by analogy. In the approach an important role play knowledge bases and interactions with them. Some illustrative applications of the proposed approach related to real-life projects (e.g., respiratory failure, UAV control, algorithmic trading, sunspot classification, semantic search engine, firefighter safety) are reported. We emphasize the pivotal role of the proposed approach for risk management in complex systems, including the systems supported by Active Media Technology.

### **Speaker Biography**

Andrzej Skowron received the Ph. D. and D. Sci. (habilitation) from the University of Warsaw in Poland. In 1991 he received the Scientific Title of Professor. He is Full Professor in the Faculty of Mathematics, Computer Science and Mechanics at the University of Warsaw. He is ECCAI Fellow. Andrzej Skowron is the (co)author of more than 400 scientific publications and editor of many books. His areas of expertise include reasoning with incomplete information, approximate reasoning, soft computing methods and applications, rough sets, rough mereology, granular computing, intelligent systems, knowledge discovery and data mining, decision support systems, adaptive and autonomous systems, perception based computing, interactive computational systems. He was the supervisor of more than 20 PhD Thesis. In the period 1995-2009 he was the Editor-in-Chief of *Fundamenta Informaticae* journal. He is on Editorial Boards of many others international journals. Andrzej Skowron was the President of the International Rough Set Society from 1996 to 2000. He has delivered numerous invited talks at international conferences including plenary talk at the 16-th IFIP World Computer Congress (Beijing, 2000), keynote talk at 8th Joint Conference on Information Sciences (JCIS 2005) (encompassing 12 individual conferences and workshops) (USA, 2005), invited talk at 2006 IEEE/WIC/ACM International Conference on Intelligent Agent Technology (IAT 2006) and on Web Intelligence (WI 2006) (Hong Kong, 2006), and plenary talk at the 2-nd World Congress on Biologically Inspired Computing (Japan, 2010). He was serving as (co-)program chair and PC member of more than 100 international conferences. He was involved in numerous research and commercial projects including dialog-based search engine (Nutech), fraud detection for Bank of America (Nutech), logistic project for General Motors (Nutech), algorithmic trading (Adgam), control of UAV (Linkoeping University), medical decision support (Polish-American Pediatric Clinic in Cracow).

**AMT Keynote Lecture***Chaired by Prof. Jiannong Cao**(9:00a.m.-10:00a.m., October 31, 2013)*

Yuzuru Tanaka

Professor at Hokkaido University, Japan

***Meme Media and Knowledge Federation in the Age of Big Data*****Abstract**

Meme media research started with the proposal of the synthetic media architecture IntelligentPad and its implementation in Smalltalk 80 in 1989. This architecture was then reoriented in 1993 to meme media and meme pool architectures. The dissemination of Web browsers around that time made us consider how to use the Web as a world-wide meme pool, i.e., a repository of meme media objects. Then we came across the problem of how to wrap a whole Web resource like Web applications or Web services and/or an embedded Web resource into a meme media object. Once wrapped, such resources can be easily combined together to interoperate with each other. This idea opened a new vista of knowledge federation, i.e., dynamic federation of knowledge resources over the Web. Knowledge federation requires two new technologies, i.e., one to extract an embedded knowledge resource from a Web document, and the other to wrap the extracted resource into a meme media object. This idea, however, requires two different environments, i.e., the Web environment and a meme media system environment. The ideal solution was to unify these two environments, which resulted in the proposal of the Webble World system. This talk will briefly review the history of our R&D on meme media and knowledge federation, and give their new perspectives in the age of big data by showing the two large-scale practical applications of the Webble World technology. One is the integrated visual environment for supporting different stages of clinical trials on cancer including the design of the trial master plan and the CRF (Case Report Form) of each treatment event by the trial chairman, the guidance of patient treatment and data input during the treatment of each patient by a clinician, and the exploratory visual analytics of the accumulated trial data for data analysts to find out better personalized medicine. The other is the optimization of the snow plowing and removing in Sapporo City through the exploratory visual analytics of a variety of retrospective and real-time data including probe car data, probe person data, meteorological data, snow-plowing and removing records, traffic accidents, tweets, etc. The talk will focus on the ill-formed nature of these problems, the necessity of exploratory visual analytics with an open large library of tools and services and their improvisational federation capability, and how meme media and knowledge federation will give answers to these requirements in the age of data.

**Speaker Biography**

1985-1986: Visiting research fellow at IBM T.J. Watson Research Center, is a fellow of both Information Processing Society of Japan and Japanese Society of Software Science.

2004-: Professor of Knowledge media architecture at the Department of Computer Science, Graduate School of Information Science and Technology, Hokkaido University, and adjunct professor of National Institute of Informatics and is also an affiliated scientist of FORTH (Institute of Computer Science, Foundation for Research and Technology-Hellas)

2013-: Working as the program officer of a new 8 year CREST program of JST on big data application technologies, and also as an education and research councilor of Research Organization of Information and Systems consisting of seven national research institutes and centers in Japan.

His current research areas include meme media architectures (a component-based media architecture for the reediting and redistribution of knowledge resources among people), knowledge federation frameworks, proximity-based federation of smart objects, and their application to digital libraries, e-Science, explorative visual analytics for clinical trial big data, and a social cyber-physical system for optimizing complex social system services such as snow plowing and removing in Sapporo and for disaster management and response.

## ***BHI Keynote Lecture***

*Chaired by Prof. Tomoaki Shirao*

*(10:20a.m.-11:20a.m., October 31, 2013)*



Marcel A. Just

Professor at Carnegie Mellon University, USA

## ***The Neural Structure of Human Concepts: Applying Machine Learning and Factor Analysis to Brain Imaging Data***

### **Abstract**

This talk will describe the discovery of a set of biologically-driven semantic dimensions of thought that underlie the brain representation of familiar concepts. The main thesis is that the subsystems of the human brain provide the building blocks for the neural representation of all concepts. Our research applies machine learning and factor analysis methods to fMRI brain images acquired while subjects are thinking about individual concepts.

For example, the brain representation of individual concrete nouns like hammer or apple has three main neurosemantic factors underpinning their brain representation, factors which we label manipulation, shelter, and eating. When we encounter a concrete inanimate object, we mentally catalog it primarily in terms of how our bodies interact with the object (the manipulation factor), how we can be sheltered or enclosed by it, and how we can eat it. Each of these factors is neurally represented in 3-4 different brain locations corresponding to a cortical network of co-activating regions. In this example, the neural representation of an apple consists of motor representations of holding an apple, as well as representations of mouth movement and tasting an apple. This general approach provides a way to identify a person's thought from their fMRI activity, with good accuracy.

Furthermore, the approach is extensible to other types of concepts, such as numerical quantities, interpersonal interactions, and emotions. A future application of the approach is diagnosis of a psychiatric alteration in thought based on the alterations in the fMRI signatures of critical concepts.

### **Speaker Biography**

Marcel Adam Just, the D.O. Hebb Professor of Cognitive Neuroscience at Carnegie Mellon and Director of its Center for Cognitive Brain Imaging, is a researcher and scientific contributor in a broad set of areas of neuroscience, with major funding for over three decades from NIH (including a Senior Scientist Award) and ONR (Office of Naval Research). He is the 2012 recipient of the Distinguished Scientific Contribution Award from the Society of Text & Discourse. He has made pioneering brain imaging contributions in autism, dyslexia, multitasking, and thought identification (from brain images) that have been published in leading journals. He is the developer of one of the leading theories of autism, has helped to develop the first successful attempt to decode a simple thought from a person's brain activity (published in *Science*), has demonstrated the brain consequences of cell phone use during driving, and has demonstrated for the first time that the brains of children who are poor readers can be changed, not just in how they activate, but also in their very anatomy. In addition to the scientific research, he has also been involved in relating neuroscience findings to public policy, including providing testimony on the biological basis of autism to the U.S. House of Representatives Government Reform Subcommittee on Human Rights & Wellness, and testimony on cell phone use during driving to the Pennsylvania House of Representatives Transportation Committee Hearing.

***BHI Keynote Lecture****Chaired by Prof. Shiro Usui**(11:20a.m.-12:20p.m., October 31, 2013)***Jiming Liu**

Professor at Hong Kong Baptist University  
Hong Kong SAR, China

***A Complex Systems Approach towards a Better Understanding of Healthcare*****Abstract**

In this talk, I will present our recent research work on modeling a complex healthcare system. Through a systematic study on wait times, we aim to understand: (1) the causal relationships between connected units in the system, (2) the impacts of neighborhood profiles and hospital characteristics on service utilization and wait times, and (3) the effectiveness of adaptive resource allocation in improving system performances. The research questions and methods (involving structural equation modeling, queuing modeling, and multi-agent autonomy-oriented computing (AOC) simulation), as to be discussed in the talk, can readily offer practical insights into new ways of evidence-based healthcare policy making.

**Speaker Biography**

Prof. Liu has served professional communities in various capacities, e.g., Editor-in-Chief of Web Intelligence and Agent Systems, Associate Editor of IEEE Transactions on Knowledge and Data Engineering (2005-2009), IEEE Transactions on Systems, Man, and Cybernetics, Part B (2009-), and Computational Intelligence (2007-) etc., Editorial Board Member of several other journals, General (Co-)Chair or Program (Co-)Chair of international conferences (IHI'12, ISMIS'12, ICDM'06, WI/IAT'05, EEE'04, IDEAL'03, WI/IAT'01, and IAT'99 etc.), Chair of IEEE Computer Society Technical Committee on Intelligent Informatics (TCII) (2010-), IEEE Computer Society Fellows Committee Member (2011), Co-Director of Web Intelligence Consortium (WIC), Member of Hong Kong Research Grants Council (RGC) Engineering Panel (2004-2010), and Member of Hong Kong Young Scientist Award Selection Panel (2002-).

He is Chair Professor in Computer Science and Associate Dean (Research and Graduate Studies) of the Faculty of Science at Hong Kong Baptist University (HKBU). He received M.Eng. and Ph.D. in Electrical Engineering from McGill University, Montreal, after obtaining Master of Arts from Concordia University and B.Sc. in Physics from East China Normal University, Shanghai. Before 1994, he worked in the IT industry in Canada (e.g., Computer Research Institute of Montreal (CRIM), Virtual Prototypes Inc. (VPI), and Knowledge Engineering Technology Inc. (KENTEK)).

# AMT-BHI Panel

## *Brain Big Bata in the Hyper World*

*(3:30p.m.-5:30p.m., October 30, 2013)*

### **Background**

The "hyper world" means a new world that is emerging by coupling and empowering humans in the social world, information/computers in the cyber world, and things in the physical world. Active Media Technology (AMT) and Brain/Health Informatics (BHI) offer informatics-enabled brain studies and applications in the hyper world, which can be regarded as a brain big data cycle. This brain big data cycle is implemented by measuring, collecting, modeling, transforming, managing, mining, interpreting, and explaining multiple forms of brain big data obtained from atomic and molecular levels to the entire brain by using powerful equipment such as fMRI, EEG, MEG, PET, NIRS and OCT, as well as various wearable, ubiquitous, active, micro and nano devices. Such brain big data will not only help scientists improve their understanding of human thinking, learning, decision-making, and memory, but could help cure disease, serve health-care, and develop human-level wisdom computing in the hyper world. Thus, some suggested issues for the panel discussions include:

*How would brain big data and the hyper world interact?*

*How will we gain from such interactions?*

*What do you see as bigs?*

*What would be the basic model for brain big data representation and integration?*

*How would brain big data be collected, curated, mined and used in the hyper world?*

*How would we understand human brain as information processing system with big data?*

*How would we understand and apply the heart of big data?*

*What are the requirements on brain big data from the systematic intelligence study?*

*What are the requirements on brain big data from the intelligence industry?*

*What would be the dark side of brain big data in the hyper world?*

*How should we prepare to deal with the above issues?*

This panel provides a good opportunity for researchers and practitioners from diverse fields to participate in cutting-edge discussions.

**Chair**

Stephen S. Yau, Arizona State University, USA



**Panelists and Their Fields**

Jianhua Ma, Hosei University, Japan

*"Hyber-world & Cyber-I"*

Shinsuke Shimojo, California Institute of Technology, USA

*"Perception and Cognition"*

Marcel A. Just, Carnegie Mellon University, USA

*"fMRI Studies of Human Thought"*

Bin Hu, Lanzhou University, China

*"Mental Health & Ubiquitous EEG"*

Guoyin Wang, Chongqing University of Posts and Telecommunications, China

*"Cognitive, Granular, & Cloud Models"*

Kazuhiro Oiwa, National Institute of Information and Communications Technology, Japan

*"Heart-to-Heart Science"*

Yuichiro Anzai, Japan Society for the Promotion of Science, Japan

*"Cognitive and Information Sciences"*



# Social Events

## *Tuesday, October 29*

---

<b>9:00a.m. - 9:30a.m.</b>	<b>Room A (2F Hall)</b>	Opening
<b>1:15p.m. - 1:45p.m.</b>	<b>Room A (2F Hall)</b>	Mini-concert by the orchestral music circle of Maebashi Institute of Technology
<b>6:00p.m. - 8:00p.m.</b>	<b>Room B (8F KEYAKI)</b>	Welcome Reception (with the ukulele music by the Kasukawa circle)

## *Wednesday, October 30*

---

<b>1:15p.m. - 1:45p.m.</b>	<b>Room A (2F Hall)</b>	Mini-concert by Gunma Univ. Mandolin Society
<b>6:00p.m. - 8:00p.m.</b>	<b>Room B (8F KEYAKI)</b>	Conference Banquet (with the Japanese drum performance by the Joshu Ogo Fujin preservation society)

## *Thursday, October 31*

---

<b>12:30p.m. - 1:00p.m.</b>	<b>Room A (2F Hall)</b>	A video show of the world heritage of Tomioka filature
<b>3:45p.m. - 6:00p.m.</b>		Optional Tours i) Gunma university heavy ion medical center ii) Japanese tea ceremony in Rinkoukaku of Maebashi Park



# General Information

## *About the Conference*

### On-Site Registration Hours

---

Monday, 28 October 2013	2:00 p.m.- 6:00 p.m.
Tuesday, 29 October 2013	8:30 a.m.- 6:00 p.m.
Wednesday, 30 October 2013	8:30 a.m.- 6:00 p.m.
Thursday, 31 October 2013	8:30 a.m.- 6:00 p.m.

### *General Inquiries*

For queries, please email to [imamurak@maebashi-it.ac.jp](mailto:imamurak@maebashi-it.ac.jp)

### *Welcome Reception*

Tuesday, October 29, 6:00 p.m. - 8:00 p.m., at 8F ROOM B (KEYAKI) of Maebashi TERRSA, located at 2-5-1, Chiyodamachi, Maebashi-city, Gunma, Japan

### *Conference Banquet*

Wednesday, October 30, 6:00 p.m. - 8:00 p.m., at 8F ROOM B (KEYAKI) of Maebashi TERRSA, located at 2-5-1, Chiyodamachi, Maebashi-city, Gunma, Japan

### *Volunteers*

You may ask Volunteers for help for any questions. They will be happy to help you.

### *Name Tags*

Each badge carries the name and affiliation of the badge holder. Admission to the welcome reception, conference and workshop sessions is by badge only. If you lose your badge, please go to the Registration Desk for a replacement.

### *Language*

The conference and all its activities will be conducted in English.

***Note to Speakers***

If you are scheduled to present, please ensure your PowerPoint is loaded in advance of your presentation time. Please visit the Registration Desk if you have any questions or for further details.

***Lunches, Morning and Afternoon Coffees and Teas***

Morning and afternoon coffees and teas, lunches on the 29th, 30th and 31st October are included in the conference registration.

***Urgent Messages***

Urgent messages for delegates can be directed to the Registration Desk. Messages will be held at the Registration Desk for collection and the recipient will be notified via a notice board.

***Internet Access***

WiFi Internet access is available at the conference venue. You will be provided with a login and a password at the Registration Desk.

***Mobile Phones & Laptop Sound***

As a courtesy to presenters and colleagues, please ensure that all mobile phones and sound from your laptop are switched off during the conference sessions.

***Smoking Area***

Delegates should be aware that smoking is forbidden by the Japan law in all public areas and transports in Japan.

***Refreshment***

Free beverage (in a limited quantity) is available in Rm. Oze (9th floor) during the period.

## ***About Gunma***

### ***Location***

Gunma is part of Japan's territory located on the Kanto Northwest, at latitude 36°3' North, longitude 138°45' East. It located 114 kilometers from Tokyo.

### ***Time***

Gunma is nine hours ahead of Greenwich Mean Time.

### ***Language***

Japanese is the official language. The official language is used in government departments and all official documents and communication.

### ***Climate***

Maebashi has a humid subtropical climate. In autumn the temperature is comparatively mild and, depending on the weather, the temperature can drop in the early mornings and late nights. In the annual, average temperature is about 14°C (57°F) and ranges from 3°C (38°F) to 26°C (79°F). Humidity levels are high and average values vary between 48% and 85%. Annual rainfall is 1,200mm, mostly during summer to autumn.

### ***Banking***

Banks are generally open from Monday to Friday during 9:00a.m. - 3:00p.m..

### ***Electricity***

Electricity in Japan is at 100V, Eastern Japan is 50Hz and Western Japan is 60Hz. All the power plugs used in Japan are of the two-pin, flat-shaped type. It is suggested to check before using an electrical appliance.



### ***Post a postcard***

The postal services of Japan are comprehensive. The post office is located at 300m to the south from the Maebashi Terra. It provides letter post, parcel & express mail services to everywhere in the world. You can post your postcard or letter at the pillar-box located in different areas of the city, which provide round-the-clock postal services.

### ***EMERGENCY CONTACT***

Urgent message of incidents and accidents to the police is 110. Emergency fire, Request of rescue and ambulance is 119.

## The Conference Venue

### *Maebashi Terrsa*

The Conference will take place at Maebashi Terrsa, and located at the downtown area within 20 minutes walking distance or 5 minutes driving distance to JR Maebashi Station.



2-5-1 Chiyodamachi  
Maebashi-city, Gunma  
Japan

Tel: 027-231-3211  
Fax: 027-231-3955

## *Getting to Maebashi*

### **1. New Tokyo International Airport (Narita Airport) to Maebashi**

There are 3 Ways to get from New Tokyo International Airport to Maebashi:

- (1) JR Trains: JR Narita Express to Tokyo -> JR to Takasaki -> Maebashi
- (2) KEISEI Trains: KEISEI Skyliner to Ueno Station -> JR to Maebashi
- (3) Airport Bus: Azalea Express bus -> Maebashi (3 and half hours)

**Azalea Express Timetable**

From Narita Airport	Arrive at Maebashi Station
8:05	11:45
9:25	13:05
11:20	15:00
13:00	16:40
14:00	17:40
14:50	18:30
15:45	19:25
16:35	20:15
17:30	21:10
18:30	22:10
19:45	23:10
20:55	0:20

### **2. Haneda Airport to Maebashi**

There are 2 Ways to get from Haneda Airport to Maebashi:

- (1) Trains: Keikyu Line to Shinagawa -> JR Yamanote Line to Tokyo -> JR to Takasaki -> Maebashi
- (2) Airport Bus: Limousine bus -> Maebashi (3 and half hours)

**Limousine Bus Timetable**

From Haneda Airport International Terminal	From Haneda Airport Terminal 2	From Haneda Airport Terminal 1	Arrive at Maebashi Station South Exit
10:50	11:00	11:05	14:25
14:30	14:40	14:45	18:05
16:30	16:40	16:45	20:00
17:30	17:40	17:45	21:10
19:30	19:40	19:45	22:35
20:30	20:40	20:45	23:35
21:30	21:40	21:45	00:20
22:30	22:40	22:45	01:00

### 3. Tokyo Station to Maebashi

There are 2 Ways to get from Tokyo Station to Maebashi:

- (1) Shinkansen: Tokyo station to Takasaki -> JR to Maebashi
- (2) JR: JR Yamanote Line to Ueno -> JR Takasaki Line to Maebashi

### *Getting to the Venue*

No matter what means of transportation you take to arrive Maebashi. You can use the following to reach the conference venue.

#### **Taxi:**

Taxi are air-conditioned and inexpensive, they are freely available at the taxi station outside the Maebashi Station.

#### **Bus:**

- (1) Gunma Bus: Maebashi Station -> Chiyodamachi Nichome -> Venue (7:40am-7:15pm)
- (2) Kanetsu Bus: Maebashi Station -> Chiyodamachi Nichome -> Venue (6:40am-9:23pm)
- (3) Nippon Chuo Bus: Maebashi Station -> Honmachi -> Venue (6:50am-6:53pm)
- (4) Jōshin Bus: Maebashi Station -> Honmachi -> Venue (7:28am-8:28pm)

### From Maebashi Station to the Venue by Walking or Bus



### Instruction of the Bus Stations on the North Side of Maebashi Station

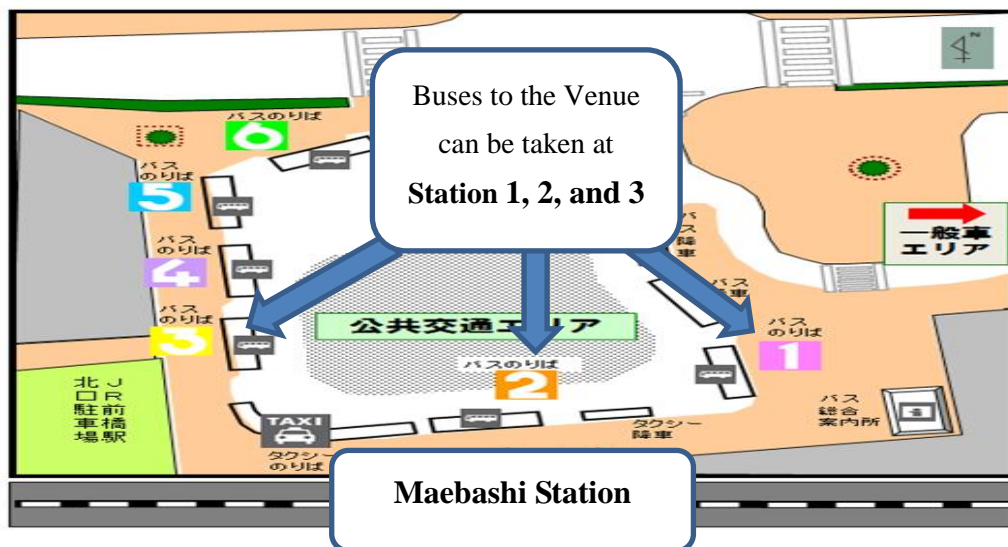



## From Hotels to the Venue

A: The conference hall-Maebashi Terrsa B: Maebashi Sakura Hotel (near the Maebashi Sun Hotel)

C: Comfort Hotel Maebashi

D: Toyoko-Inn Maebashi Ekimae



Room Map of Terrsa 2F

MAEBASHI TERRSA 2F

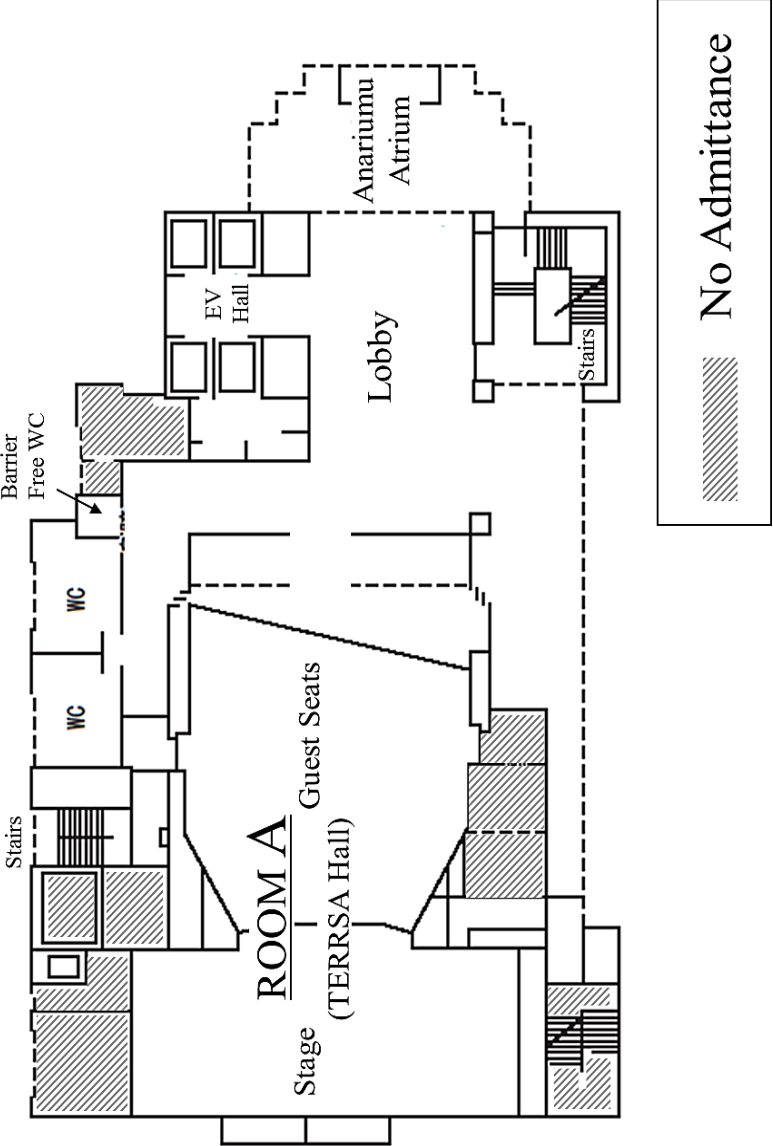

### Room Map of Terrsa 3F

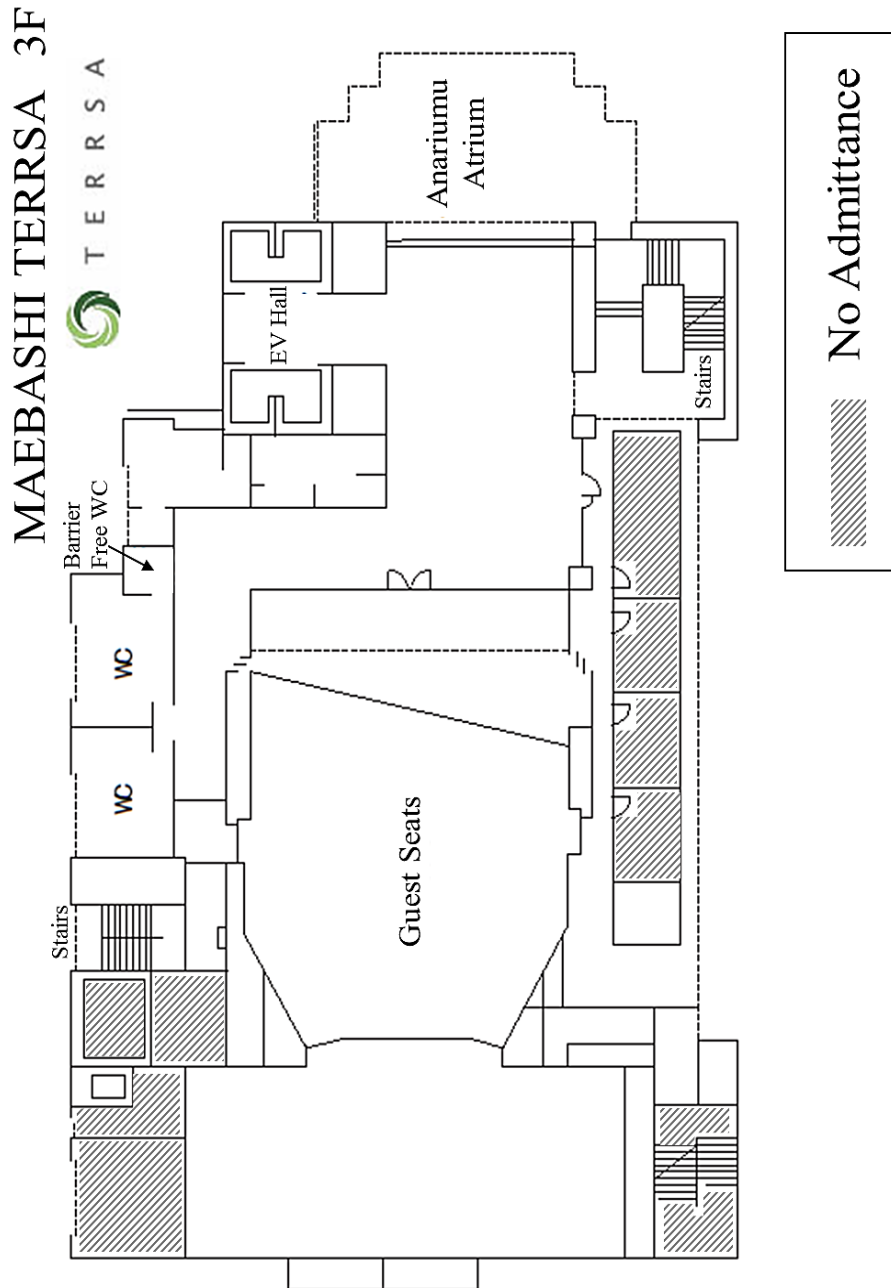

### Room Map of Terrsa 4F

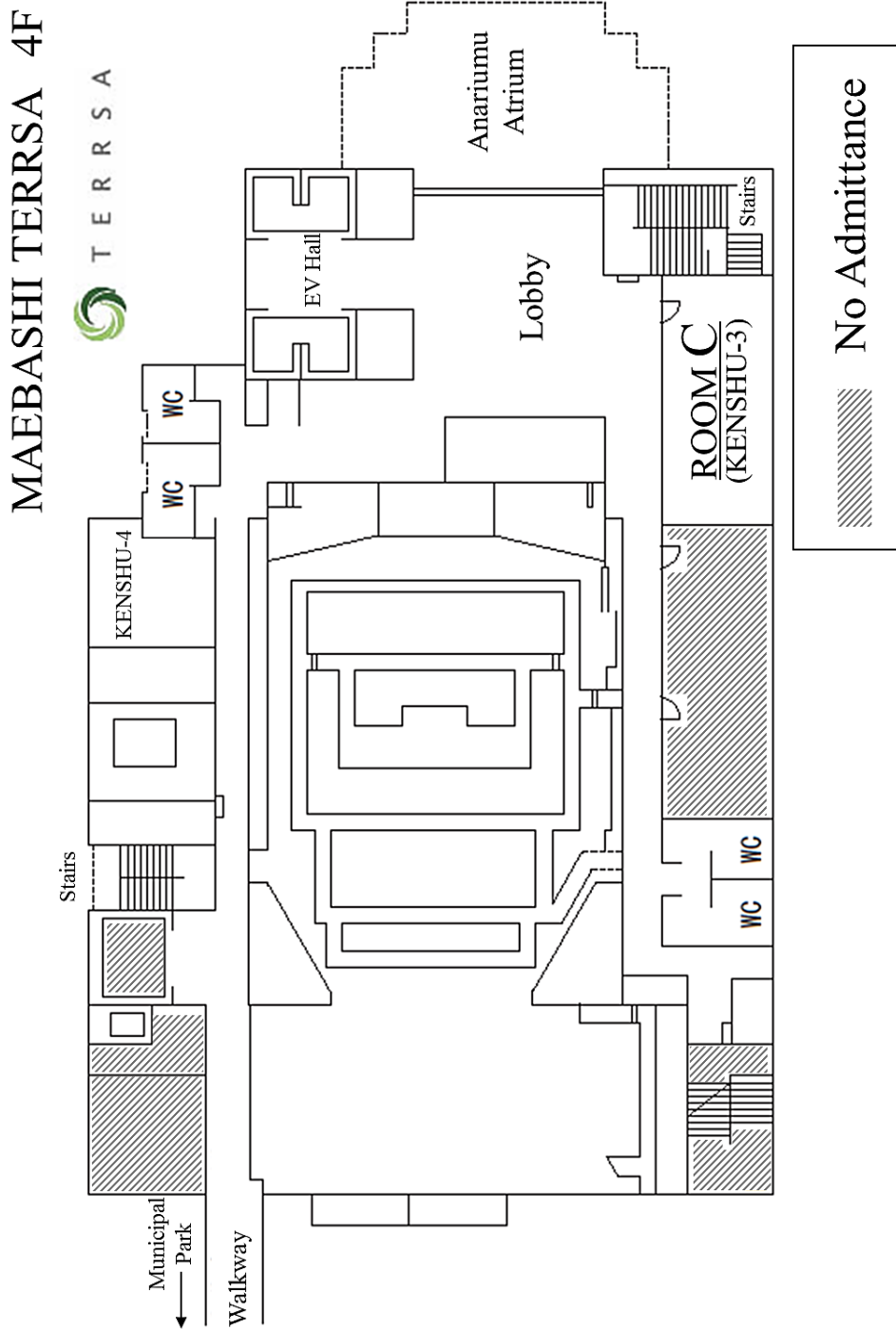

### Room Map of Terrsa 8F

MAEBASHI TERRSA 8F

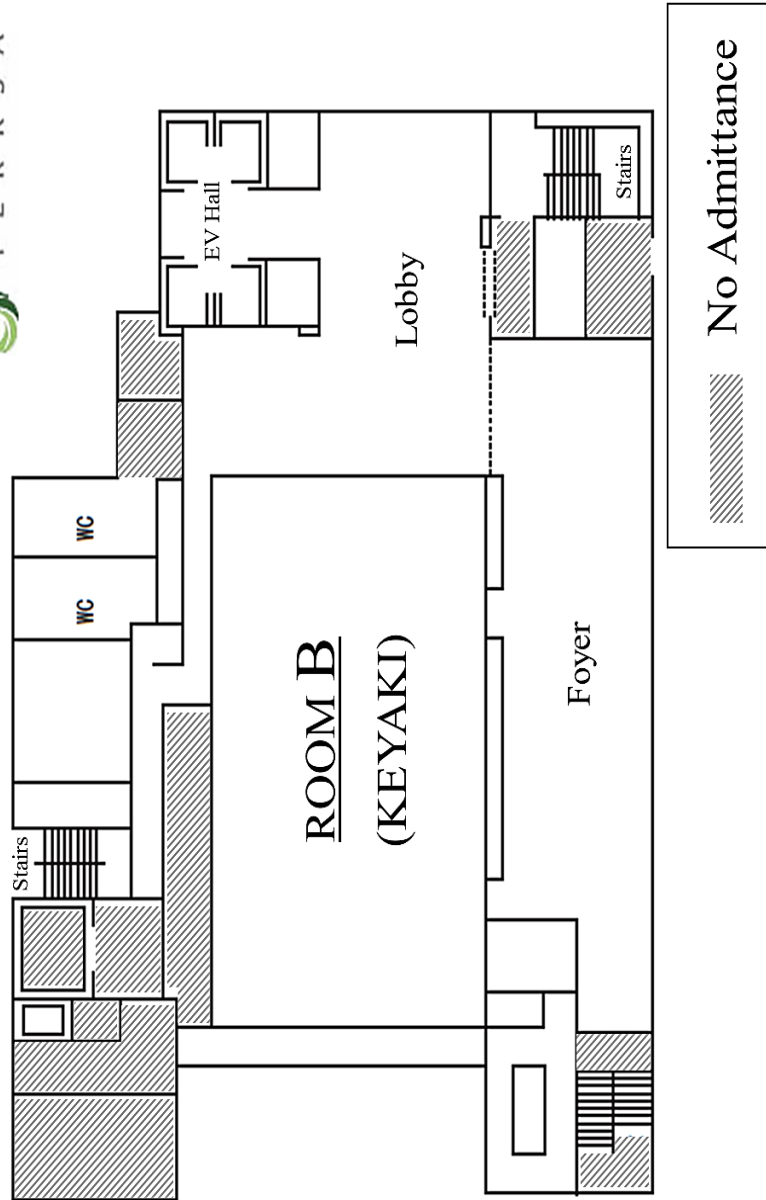

MAEBASHI TERRSA 9F

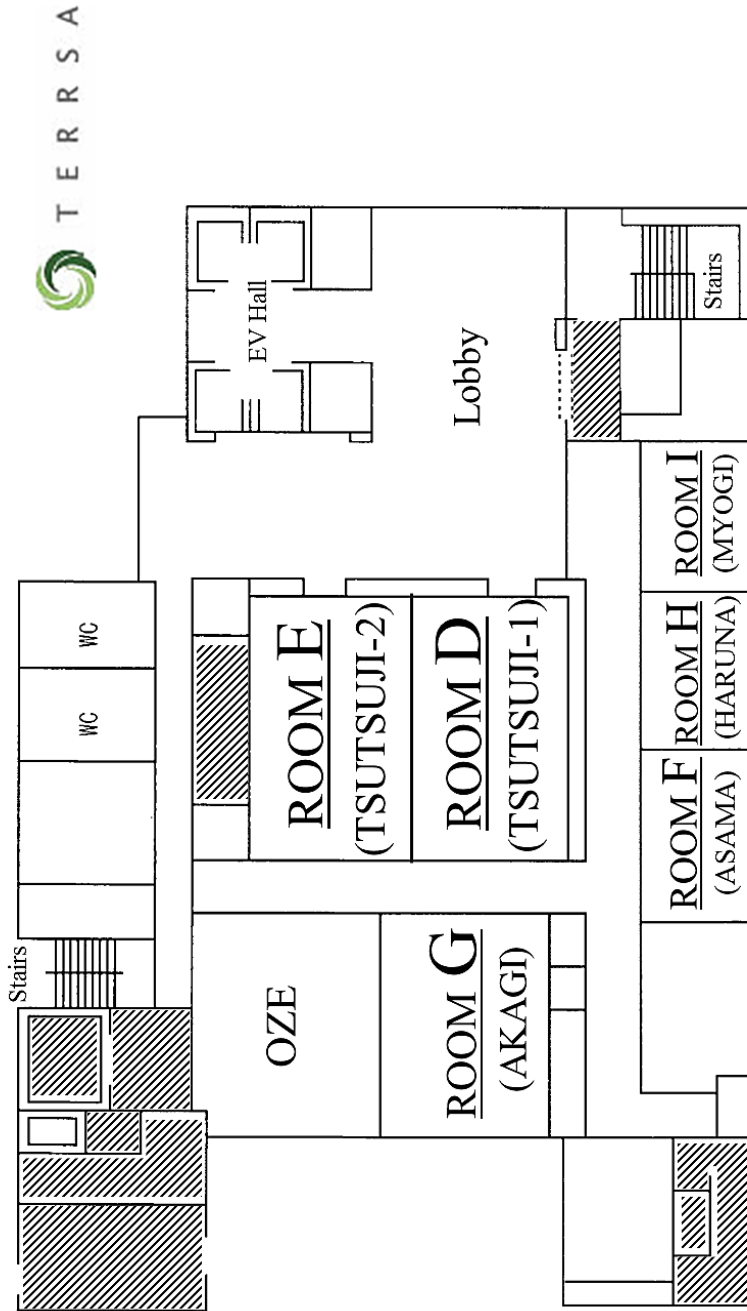

No Admittance

# Organization Committee AMT 2013

## *Conference Committee AMT 2013*

### **Honorary General Chair**

Setsuo Ohsuga                      University of Tokyo, Japan

### **Conference General Chairs**

Andrzej Skowron                      University of Warsaw, Poland

Jian-Nong Cao                      Hong Kong Polytechnic University, Hong Kong SAR, China

### **Program Chairs**

Tetsuya Yoshida                      Hokkaido University, Japan

Gang Kou                      University of Electronic Science and Technology of China, China

### **Workshop/Special Session Organizing Chair**

Hakim Hacid                      Bell Labs, France

### **Organizing Chairs**

Kazuyuki Imamura                      Maebashi Institute of Technology, Japan

Tetsumi Harakawa                      Maebashi Institute of Technology, Japan

Ning Zhong                      Maebashi Institute of Technology, Japan

### **Panel Chair**

Stephen S. Yau                      Arizona State University, USA

### **Journal Special Issue Chairs**

Xin Yao                      University of Birmingham, UK

Runhe Huang                      Hosei University, Japan

### **Publicity Chairs**

Shinichi Motomura                      Maebashi Institute of Technology, Japan

Dominik Slezak                      University of Warsaw & Infobright Inc., Poland

Jian Yang                      Beijing University of Technology, China

**WIC Co-chairs/Directors**

Ning Zhong                      Maebashi Institute of Technology, Japan  
Jiming Liu                      Hong Kong Baptist University, Hong Kong SAR, China

**IEEE CIS-TFBI Chair**

Ning Zhong                      Maebashi Institute of Technology, Japan

**WIC Advisory Board**

Edward A. Feigenbaum        Stanford University, USA  
Setsuo Ohsuga                 University of Tokyo, Japan  
Benjamin Wah                 Chinese University of Hong Kong, Hong Kong SAR, China  
Philip Yu                        University of Illinois, Chicago, USA  
L.A. Zadeh                        University of California, Berkeley, USA

**WIC Technical Committee**

Jeffrey Bradshaw              UWF/Institute for Human and Machine Cognition, USA  
Nick Cercone                  York University, Canada  
Dieter Fensel                  University of Innsbruck, Austria  
Georg Gottlob                 Oxford University, UK  
Lakhmi Jain                     University of South Australia, Australia  
Jianhua Ma                     Hosei University, Japan  
Jianchang Mao                 Yahoo! Inc., USA  
Pierre Morizet-Mahoudeaux    Compiègne University of Technology, France  
Hiroshi Motoda                Osaka University, Japan  
Toyoaki Nishida                Kyoto University, Japan  
Andrzej Skowron                Warsaw University, Poland  
Jinglong Wu                    Okayama University, Japan  
Xindong Wu                     University of Vermont, USA  
Yiyu Yao                        University of Regina, Canada



## ***Program Committee Members AMT 2013***

Ajith Abraham	Norwegian	University of Science and Technology, Norway
Gloria Bordogna		The National Research Council, Italy
Antonio Chella		The University of Palermo, Italy
Yiqiang Chen		Institute of Computing Technology, Chinese Academy of Sciences, China
Chin-Wan Chung		Korea Advanced Institute of Science and Technology, Republic of Korea
Adrian Giurca		Brandenburg University of Technology at Cottbus, Germany
William Grosky		University of Michigan, USA
Bin Guo		Northwestern Polytechnical University, China
Hakim Hacid		SideTrade, France
Yoshikatu Haruki		Ferris University, Japan
Enrique Herrera-Viedma		University of Granada, Spain
Masahito Hirakawa		Shimane University, Japan
Wolfgang Huerst		Utrecht University, The Netherlands
Hajime Imura		Hokkaido University, Japan
Hiroki Inoue		Kyoto University, Japan
Hiroshi Ishikawa		Kagawa University, Japan
Hanmin Jung		KISTI, Republic of Korea
Yoshitsugu Kakemoto		The JSOL, Ltd., Japan
Gang Kou		University of Electronic Science and Technology, China
Jing Li		University of Science and Technology of China, China
Wen-bin Li		Shijiazhuang University of Economics, China
Xining Li		University of Guelph, Canada
Xiaohui Liu		Brunel University, UK
Marco Luetzenberger		DAI-Labor, TU-Berlin, Germany
Wenji Mao		Institute of Automation, Chinese Academy of Sciences, China
Kouzou Ohara		Aoyama Gakuin University, Japan
Yoshihiro Okada		Kyushu University, Japan
Yoshiaki Okubo		Hokkaido University, Japan
Gang Pan		Zhejiang University, China
Naoki Saiwaki		Konan University, Japan
Eugene Santos		University of Connecticut, USA
Gerald Schaefer		Loughborough University, UK

Dominik Slezak	University of Warsaw & Infobright Inc., Poland
Tsuyoshi Sugibuchi	Internet Memory Research, France
Kazunari Sugiyama	National University of Singapore, Singapore
Yuqing Sun	Shandong University, China
Akio Takashima	Shohoku College, Japan
Xijin Tang	Academy of Mathematics and Systems Science, Chinese Academy of Sciences, China
Xiaohui Tao	University of Southern Queensland, Australia
Takao Terano	Tokyo Institute of Technology, Japan
Vincent Toubiana	Bell Labs France, France
Athena Vakali	Aristotle University of Thessaloniki, Greece
Egon L. Van den Broek	University of Twente/Karakter University Center, The Netherlands
Natalie van der Wal	VU University Amsterdam, The Netherlands
Neil Y. Yen	The University of Aizu, Japan
Tetsuya Yoshida	Hokkaido University, Japan
Yi Zeng	Institute of Automation, Chinese Academy of Sciences, China
Guoqing Zhang	University of Windsor, Canada
Shichao Zhang	University of Technology, Australia
Zhangbing Zhou	Institut Telecom & Management SudParis, France

**External Reviewers**

Dongmin Seo  
Dandan Zhou  
Chu Du

## Organization Committee BHI 2013

### *Conference Committee BHI 2013*

#### **Honorary General Chair**

Setsuo Ohsuga                      University of Tokyo, Japan

#### **Conference General Chairs**

Tomoaki Shirao                      Graduate School of Medicine, Gunma University, Japan

Takuji Kasamatsu                      Maebashi Institute of Technology, Japan

#### **Program Chairs**

Kazuyuki Imamura                      Maebashi Institute of Technology, Japan

Shiro Usui                              Toyohashi University of Technology, Japan

#### **Workshop/Special Session Organizing Chair**

Lars Schwabe                              University of Rostock, Germany

#### **Organizing Chairs**

Kazuyuki Imamura                      Maebashi Institute of Technology, Japan

Tetsumi Harakawa                      Maebashi Institute of Technology, Japan

Ning Zhong                              Maebashi Institute of Technology, Japan

#### **Panel Chair**

Stephen S. Yau                              Arizona State University, USA

#### **Journal Special Issue Chairs**

Xin Yao                                      University of Birmingham, UK

Runhe Huang                              Hosei University, Japan

#### **Publicity Chairs**

Shinichi Motomura                      Maebashi Institute of Technology, Japan

Dominik Slezak                              University of Warsaw & Infobright Inc., Poland

Jian Yang                                      Beijing University of Technology, China

**WIC Co-chairs/Directors**

Ning Zhong                      Maebashi Institute of Technology, Japan  
Jiming Liu                        Hong Kong Baptist University, Hong Kong SAR, China

**IEEE CIS-TFBI Chair**

Ning Zhong                      Maebashi Institute of Technology, Japan

**WIC Advisory Board**

Edward A. Feigenbaum        Stanford University, USA  
Setsuo Ohsuga                  University of Tokyo, Japan  
Benjamin Wah                  Chinese University of Hong Kong, Hong Kong SAR, China  
Philip Yu                         University of Illinois, Chicago, USA  
L.A. Zadeh                        University of California, Berkeley, USA

**WIC Technical Committee**

Jeffrey Bradshaw              UWF/Institute for Human and Machine Cognition, USA  
Nick Cercone                    York University, Canada  
Dieter Fensel                    University of Innsbruck, Austria  
Georg Gottlob                  Oxford University, UK  
Lakhmi Jain                      University of South Australia, Australia  
Jianhua Ma                       Hosei University, Japan  
Jianchang Mao                  Google, USA  
Pierre Morizet-Mahoudeaux    Compiègne University of Technology, France  
Hiroshi Motoda                 Osaka University, Japan  
Toyoaki Nishida                Kyoto University, Japan  
Andrzej Skowron                Warsaw University, Poland  
Jinglong Wu                      Okayama University, Japan  
Xindong Wu                      University of Vermont, USA  
Yiyu Yao                         University of Regina, Canada

## ***Program Committee Members BHI 2013***

Samina Abidi	Dalhousie University, Canada
Syed Sibte Raza Abidi	Dalhousie University, Canada
Susanne Boll	University of Oldenburg, Germany
Matt-Mouley Bouamrane	University of Glasgow, UK
W. Art Chaovalitwongse	University of Washington, USA
Andrzej Cichocki	RIKEN Brain Science Institute, Japan
Foad Dabiri	UCLA, USA
Xiaocong Fan	The Pennsylvania State University, USA
Philippe Fournier-Viger	University of Moncton, Canada
Hassan Ghasemzadeh	University of California Los Angeles, USA
Yike Guo	Imperial College London, UK
Takahiro Hara	Osaka University, Japan
Frank D. Hsu	Fordham University, USA
Bin Hu	Lianzhou University, China
Kazuyuki Imamura	Maebashi Institute of Technology, Japan
C.G. Johnson	The University of Kent, UK
Hanmin Jung	KISTI, Republic of Korea
Yosky Kataoka	RIKEN Center for Life Science Technologies, Japan
Renaud Lambiotte	University of Namur, Belgium
Kuan-Ching Li	Providence University, Taiwan
Peipeng Liang	Xuanwu Hospital, Capital Medical University, China
Pawan Lingras	Saint Mary's University, Canada
Xiaohui Liu	Brunel University, UK
Yan Liu	The Hong Kong Polytechnic University, SAR China
Anthony Maeder	University of Western Sydney, Australia
Hiroki Matsumoto	Maebashi Institute of Technology, Japan
Kazuhiko Nakadate	Meiji Pharmaceutical University, Japan
Goran Nenadic	University of Manchester, UK
Masato Odagaki	Maebashi Institute of Technology, Japan
Miodrag Potkonjak	University of California Los Angeles, USA
David M.W. Powers	Flinders University, Australia
Zhihai Rong	Donghua University, China

Majid Sarrafzadeh	University of California Los Angeles, USA
Hideyuki Sawada	Kagawa University, Japan
Lars Schwabe	The University of Rostock, Germany
Timothy K. Shih	National Central University, Taiwan
Sadao Shiosaka	Nara Institute of Science and Technology, Japan
Dominik Slezak	University of Warsaw and Infobright Inc., Poland
Neil Smalheiser	University of Illinois, USA
Diego Sona	Italian Institute of Technology, Italy
Piotr S. Szczepaniak	Technical University of Lodz, Poland
Xiaohui Tao	University of Southern Queensland, Australia
Shusaku Tsumoto	Shimane University, Japan
Sunil Vadera	University of Salford, UK
Egon L. Van den Broek	University of Twente / Karakter University Center, The Netherlands
Frank van der Velde	Leiden University, The Netherlands
Feng Wan	University of Macau, SAR China
Hongbin Wang	The University of Texas, USA
Jian Yang	Beijing University of Technology, China
Yiyu Yao	University of Regina, Canada
Fabio Massimo Zanzotto	University of Rome Tor Vergata, Italy
Haiyan Zhou	Beijing University of Technology, China

**Additional Reviewers**

Sung-Pil Choi  
Molly Clemens  
Usef Faghihi  
Kilby Sanchez  
Jie Xian



# AMT 2013 Author Index

Name	ID	Session time	Location	Page
Akihiko Sato	A264	October 31 (1:30pm)	Room I (9F MYOGI)	13
Akihito Kanai	SA6201	October 29 (4:00pm)	Room F (9F ASAMA)	11
Ali Akbar Ghorbani	A250	October 30 (11:00am)	Room B (8F KEYAKI)	10
Alton Y.K. Chua	A213	October 29 (4:00pm)	Room D (9F TSUTSUJI-1)	8
Atsushi Kajihara	A262	October 31 (1:30pm)	Room I (9F MYOGI)	13
Beihong Jin	SA8202	October 30 (11:00am)	Room D (9F TSUTSUJI-1)	12
Bin Jiang	A221	October 29 (2:00pm)	Room D (9F TSUTSUJI-1)	8
C. Tarn	SA7201	October 30 (9:00am)	Room D (9F TSUTSUJI-1)	12
Daishi Takahashi	A217	October 30 (9:00am)	Room B (8F KEYAKI)	9
Daji Ergu	A270	October 31 (1:30pm)	Room I (9F MYOGI)	13
David Edmundson	A251	October 30 (9:00am)	Room B (8F KEYAKI)	9
Do-Heon Jeong	SA2201	October 29 (2:00pm)	Room F (9F ASAMA)	11
Fatemeh Kaveh-Yazdy	A235	October 30 (9:00am)	Room C (4F KENSHU-3)	9
Feng Xia	A235	October 30 (9:00am)	Room C (4F KENSHU-3)	9
Fengqi Li	A235	October 30 (9:00am)	Room C (4F KENSHU-3)	9
Gang Kou	A270	October 31 (1:30pm)	Room I (9F MYOGI)	13
Gang Shen	A229	October 29 (4:00pm)	Room D (9F TSUTSUJI-1)	8
Gerald Schaefer	A251	October 30 (9:00am)	Room B (8F KEYAKI)	9
Hanmin Jung	SA2201	October 29 (2:00pm)	Room F (9F ASAMA)	11
Hanmin Jung	SA2202	October 29 (2:00pm)	Room F (9F ASAMA)	11
Hayato Yokoi	A257	October 30 (11:00am)	Room C (4F KENSHU-3)	10
Hidenao Abe	A247	October 30 (9:00am)	Room C (4F KENSHU-3)	9
Hiroki Ogino	A223	October 29 (2:00pm)	Room D (9F TSUTSUJI-1)	8
Hitoshi Morita	SA6204	October 29 (4:00pm)	Room F (9F ASAMA)	11
Hui Wang	A244	October 30 (11:00am)	Room B (8F KEYAKI)	10
Ichiro Fukumoto	A217	October 30 (9:00am)	Room B (8F KEYAKI)	9
Jangwon Gim	SA2201	October 29 (2:00pm)	Room F (9F ASAMA)	11
Jiajin Huang	A244	October 30 (11:00am)	Room B (8F KEYAKI)	10
Jia-Jin Huang	A232	October 30 (9:00am)	Room B (8F KEYAKI)	9
Jie Li	A235	October 30 (9:00am)	Room C (4F KENSHU-3)	9
Jinhyung Kim	SA2201	October 29 (2:00pm)	Room F (9F ASAMA)	11
Jinwoo Park	SA2205	October 29 (2:00pm)	Room F (9F ASAMA)	11
John Keane	SA8203	October 30 (11:00am)	Room D (9F TSUTSUJI-1)	12
Juichi Kosakaya	A241	October 30 (11:00am)	Room C (4F KENSHU-3)	10
Jumpei Ono	SA6207	October 29 (4:00pm)	Room F (9F ASAMA)	11
Jung-Ho Um	SA2202	October 29 (2:00pm)	Room F (9F ASAMA)	11
Jung-Hoon Park	SA2201	October 29 (2:00pm)	Room F (9F ASAMA)	11
Kebin Jia	A221	October 29 (2:00pm)	Room D (9F TSUTSUJI-1)	8
Kenichi Ida	SA7202	October 30 (9:00am)	Room D (9F TSUTSUJI-1)	12
Kenichi Ida	SA7203	October 30 (9:00am)	Room D (9F TSUTSUJI-1)	12
Kenichi Ida	SA7204	October 30 (9:00am)	Room D (9F TSUTSUJI-1)	12
Kenichi Ida	SA7205	October 30 (9:00am)	Room D (9F TSUTSUJI-1)	12
Kenji Sugawara	SA6203	October 29 (4:00pm)	Room F (9F ASAMA)	11
Kenta Kanetsuna	A237	October 29 (4:00pm)	Room D (9F TSUTSUJI-1)	8



<b>Name</b>	<b>ID</b>	<b>Session time</b>	<b>Location</b>	<b>Page</b>
Kiryu Ibara	A237	October 29 (4:00pm)	Room D (9F TSUTSUJI-1)	8
Kittisak Kerdprasop	A263	October 31 (1:30pm)	Room I (9F MYOGI)	13
Kiyoshi Hoshino	A265	October 31 (1:30pm)	Room F (9F ASAMA)	13
Kiyoshi Tokunaga	A258	October 31 (1:30pm)	Room F (9F ASAMA)	13
Kiyoshi Tsukagoshi	SA7201	October 30 (9:00am)	Room D (9F TSUTSUJI-1)	12
Kiyoshi Tsukagoshi	SA7203	October 30 (9:00am)	Room D (9F TSUTSUJI-1)	12
Kohei Matsumura	A257	October 30 (11:00am)	Room C (4F KENSHU-3)	10
Kosuke Kaneko	A255	October 30 (11:00am)	Room B (8F KEYAKI)	10
Kyounguk Lee	SA2205	October 29 (2:00pm)	Room F (9F ASAMA)	11
Kyungsun Kim	SA2205	October 29 (2:00pm)	Room F (9F ASAMA)	11
Liam Cervante	A216	October 29 (2:00pm)	Room D (9F TSUTSUJI-1)	8
Lihua Yue	SA8204	October 30 (11:00am)	Room D (9F TSUTSUJI-1)	12
Liyen Wong	SA8203	October 30 (11:00am)	Room D (9F TSUTSUJI-1)	12
Masahito Hirakawa	A237	October 29 (4:00pm)	Room D (9F TSUTSUJI-1)	8
Masaki Shiga	A262	October 31 (1:30pm)	Room I (9F MYOGI)	13
Masashi Katsumata	A224	October 30 (9:00am)	Room B (8F KEYAKI)	9
Maybin Muyeba	SA8203	October 30 (11:00am)	Room D (9F TSUTSUJI-1)	12
Mitsuo Gen	SA7204	October 30 (9:00am)	Room D (9F TSUTSUJI-1)	12
Mitsuo Gen	SA7205	October 30 (9:00am)	Room D (9F TSUTSUJI-1)	12
Mizuki Sakamoto	A226	October 30 (9:00am)	Room B (8F KEYAKI)	9
Montri Wiboonrat	A268	October 31 (1:30pm)	Room F (9F ASAMA)	13
Mostafa Karamibekr	A250	October 30 (11:00am)	Room B (8F KEYAKI)	10
Myunggwon Hwang	SA2201	October 29 (2:00pm)	Room F (9F ASAMA)	11
Ning Zhong	A232	October 30 (9:00am)	Room B (8F KEYAKI)	9
Ning Zhong	A244	October 30 (11:00am)	Room B (8F KEYAKI)	10
Niran Chawla	A268	October 31 (1:30pm)	Room F (9F ASAMA)	13
Nittaya Kerdprasop	A263	October 31 (1:30pm)	Room I (9F MYOGI)	13
Noriaki Fujishima	A265	October 31 (1:30pm)	Room F (9F ASAMA)	13
Peiquan Jin	SA8204	October 30 (11:00am)	Room D (9F TSUTSUJI-1)	12
Remo Job	A233	October 30 (11:00am)	Room B (8F KEYAKI)	10
Sajjad Mazhar	SA2201	October 29 (2:00pm)	Room F (9F ASAMA)	11
Sa-kwang Song	SA2201	October 29 (2:00pm)	Room F (9F ASAMA)	11
Sayaka Akioka	A226	October 30 (9:00am)	Room B (8F KEYAKI)	9
Sen Li	SA8202	October 30 (11:00am)	Room D (9F TSUTSUJI-1)	12
Seonug-hun Park	SA2204	October 29 (2:00pm)	Room F (9F ASAMA)	11
Seungwoo Lee	SA2202	October 29 (2:00pm)	Room F (9F ASAMA)	11
Shao Ying Zhu	A251	October 30 (9:00am)	Room B (8F KEYAKI)	9
Shigeru Osawa	A262	October 31 (1:30pm)	Room I (9F MYOGI)	13
Shinichi Nakasuka	A246	October 30 (9:00am)	Room C (4F KENSHU-3)	9
Shohei Imabuchi	SA6206	October 29 (4:00pm)	Room F (9F ASAMA)	11
Shouhong Wan	SA8204	October 30 (11:00am)	Room D (9F TSUTSUJI-1)	12
Shozo Wada	SA7201	October 30 (9:00am)	Room D (9F TSUTSUJI-1)	12
Snehasish Banerjee	A213	October 29 (4:00pm)	Room D (9F TSUTSUJI-1)	8
Songrit Maneewongvatana	A245	October 30 (9:00am)	Room C (4F KENSHU-3)	9
Sung-Ho Shin	SA2202	October 29 (2:00pm)	Room F (9F ASAMA)	11
Sung-min Kim	SA2204	October 29 (2:00pm)	Room F (9F ASAMA)	11
Sung-Pil Choi	SA2202	October 29 (2:00pm)	Room F (9F ASAMA)	11
Takahiro Hayashi	A258	October 31 (1:30pm)	Room F (9F ASAMA)	13
Takahiro Hayashi	A259	October 31 (1:30pm)	Room I (9F MYOGI)	13

<b>Name</b>	<b>ID</b>	<b>Session time</b>	<b>Location</b>	<b>Page</b>
Takahiro Hayashi	A264	October 31 (1:30pm)	Room I (9F MYOGI)	13
Takanori Ohsugi	SA6203	October 29 (4:00pm)	Room F (9F ASAMA)	11
Takao Yokota	SA7201	October 30 (9:00am)	Room D (9F TSUTSUJI-1)	12
Takao Yokota	SA7203	October 30 (9:00am)	Room D (9F TSUTSUJI-1)	12
Takashi Ishikawa	A243	October 30 (11:00am)	Room C (4F KENSHU-3)	10
Takashi Ogata	SA6206	October 29 (4:00pm)	Room F (9F ASAMA)	11
Takashi Ogata	SA6207	October 29 (4:00pm)	Room F (9F ASAMA)	11
Takeaki Taguchi	SA7201	October 30 (9:00am)	Room D (9F TSUTSUJI-1)	12
Takeshi Matsuda	A230	October 31 (1:30pm)	Room F (9F ASAMA)	13
Takeya Toyama	A217	October 30 (9:00am)	Room B (8F KEYAKI)	9
Tania Cerni	A233	October 30 (11:00am)	Room B (8F KEYAKI)	10
Tatsuo Nakajima	A226	October 30 (9:00am)	Room B (8F KEYAKI)	9
Tetsumi Harakawa	A262	October 31 (1:30pm)	Room I (9F MYOGI)	13
Tetsuya Yoshida	A215	October 29 (2:00pm)	Room D (9F TSUTSUJI-1)	8
Tetsuya Yoshida	A223	October 29 (2:00pm)	Room D (9F TSUTSUJI-1)	8
Tetsuya Yoshida	A256	October 30 (9:00am)	Room C (4F KENSHU-3)	9
Toshiki Shizuka	SA7202	October 30 (9:00am)	Room D (9F TSUTSUJI-1)	12
Toshiyasu Kato	A243	October 30 (11:00am)	Room C (4F KENSHU-3)	10
Toyoaki Nishida	A252	October 30 (11:00am)	Room C (4F KENSHU-3)	10
Tustanah Phukhachee	A245	October 30 (9:00am)	Room C (4F KENSHU-3)	9
Valerie Edward-Jones	SA8203	October 30 (11:00am)	Room D (9F TSUTSUJI-1)	12
Weidong Liu	SA8201	October 30 (11:00am)	Room D (9F TSUTSUJI-1)	12
Xi Yuan	A232	October 30 (9:00am)	Room B (8F KEYAKI)	9
Xiangfeng Luo	SA8201	October 30 (11:00am)	Room D (9F TSUTSUJI-1)	12
Xiangjie Kong	A235	October 30 (9:00am)	Room C (4F KENSHU-3)	9
Xiaoying Gao	A216	October 29 (2:00pm)	Room D (9F TSUTSUJI-1)	8
Yasser Mohammad	A252	October 30 (11:00am)	Room C (4F KENSHU-3)	10
Yasushi Kambayashi	A205	October 29 (4:00pm)	Room D (9F TSUTSUJI-1)	8
Yasuyuki Sumi	A257	October 30 (11:00am)	Room C (4F KENSHU-3)	10
Yi Peng	A219	October 30 (9:00am)	Room B (8F KEYAKI)	9
Yiyi Zhao	A219	October 30 (9:00am)	Room B (8F KEYAKI)	9
Yoji Kawamura	SA6202	October 29 (4:00pm)	Room F (9F ASAMA)	11
Yoshihiro Okada	A255	October 30 (11:00am)	Room B (8F KEYAKI)	10
Yoshitsugu Kakemoto	A246	October 30 (9:00am)	Room C (4F KENSHU-3)	9
Young-guk Ha	SA2204	October 29 (2:00pm)	Room F (9F ASAMA)	11
Yousuke Taguchi	A217	October 30 (9:00am)	Room B (8F KEYAKI)	9
Yu Xia	SA8204	October 30 (11:00am)	Room D (9F TSUTSUJI-1)	12
Yuhei Yamaguchi	A259	October 31 (1:30pm)	Room I (9F MYOGI)	13
Yuki Onodera	A205	October 29 (4:00pm)	Room D (9F TSUTSUJI-1)	8
Yusuke Kikuchi	SA7204	October 30 (9:00am)	Room D (9F TSUTSUJI-1)	12
Yusuke Manabe	SA6203	October 29 (4:00pm)	Room F (9F ASAMA)	11
Yuu Yamada	A256	October 30 (9:00am)	Room C (4F KENSHU-3)	9
Yuwei Yang	SA8202	October 30 (11:00am)	Room D (9F TSUTSUJI-1)	12
Zegang Xie	A229	October 29 (4:00pm)	Room D (9F TSUTSUJI-1)	8
Zhiguo Gong	SA8203	October 30 (11:00am)	Room D (9F TSUTSUJI-1)	12
Zhisheng Huang	A244	October 30 (11:00am)	Room B (8F KEYAKI)	10
Zhonghua Sun	A221	October 29 (2:00pm)	Room D (9F TSUTSUJI-1)	8

# BHI 2013 Author Index

Name	ID	Session time	Location	Page
Abduljalil Mohamed	B209	October 30 (9:00am)	Room I (9F MYOGI)	16
Abdulkadir Sengur	B247	October 29 (2:00pm)	Room H (9F HARUNA)	23
Abdulkadir Sengur	B280	October 29 (2:00pm)	Room I (9F MYOGI)	23
Aki Hirai Morita	SB3202	October 30 (11:00am)	Room F (9F ASAMA)	21
Akihiko Matsumura	HI3	October 31 (1:30pm)	Room D (9F TSUTSUJI-1)	22
Akinori Machino	B271	October 31 (1:30pm)	Room G (9F AKAGI)	25
Akito Saito	HI3	October 31 (1:30pm)	Room D (9F TSUTSUJI-1)	22
Alberto Casagrande	B218	October 31 (1:30pm)	Room E (9F TSUTSUJI-2)	17
Alfredo Milani	SB8202	October 30 (11:00am)	Room E (9F TSUTSUJI-2)	20
Alicia Voisine	B243	October 30 (11:00am)	Room G (9F AKAGI)	16
Amina Merzoug	B234	October 29 (4:00pm)	Room H (9F HARUNA)	24
Amr Mohamed	B209	October 30 (9:00am)	Room I (9F MYOGI)	16
Amy Batallones	B236	October 30 (9:00am)	Room G (9F AKAGI)	15
Andrei Coronel	B224	October 30 (11:00am)	Room H (9F HARUNA)	17
Ang Li	SB1202	October 29 (4:00pm)	Room E (9F TSUTSUJI-2)	19
Anggraeini Puspitasari	HI4	October 31 (1:30pm)	Room D (9F TSUTSUJI-1)	22
Anggraeini Puspitasari	B245	October 31 (1:30pm)	Room G (9F AKAGI)	25
Anna Christine Amarra	B224	October 30 (11:00am)	Room H (9F HARUNA)	17
Arika Fukushima	B225	October 29 (4:00pm)	Room G (9F AKAGI)	14
Atsu Todo	B212	October 30 (11:00am)	Room H (9F HARUNA)	17
Aurelio Pinheiro	B222	October 30 (9:00am)	Room I (9F MYOGI)	16
Ayumi Omura	B258	October 29 (4:00pm)	Room H (9F HARUNA)	24
Aziza Kawsar Parvin	SB3202	October 30 (11:00am)	Room F (9F ASAMA)	21
Azizi Ab Aziz	B241	October 30 (11:00am)	Room G (9F AKAGI)	16
Bartosz Krawczyk	B231	October 30 (11:00am)	Room H (9F HARUNA)	17
Benyun Shi	SB8204	October 30 (11:00am)	Room E (9F TSUTSUJI-2)	20
Bibo Hao	SB1203	October 29 (4:00pm)	Room E (9F TSUTSUJI-2)	19
Bin Hu	SB1201	October 29 (4:00pm)	Room E (9F TSUTSUJI-2)	19
Bin Wang	B211	October 31 (1:30pm)	Room E (9F TSUTSUJI-2)	17
Blandine Landrieu	B255	October 29 (4:00pm)	Room H (9F HARUNA)	24
Bob Li	B277	October 29 (4:00pm)	Room I (9F MYOGI)	24
Bradley Chase	B249	October 29 (4:00pm)	Room I (9F MYOGI)	24
Brian Mott	B236	October 30 (9:00am)	Room G (9F AKAGI)	15
C. Lambden	B217	October 30 (9:00am)	Room H (9F HARUNA)	15
C. Price	B217	October 30 (9:00am)	Room H (9F HARUNA)	15
Cameron McMunn-Coffran	B236	October 30 (9:00am)	Room G (9F AKAGI)	15
Chao Wu	B206	October 29 (4:00pm)	Room G (9F AKAGI)	14
Charlotte Gerritsen	B204	October 29 (2:00pm)	Room G (9F AKAGI)	14
Chi Zhu	SB6202	October 30 (9:00am)	Room F (9F ASAMA)	20
Chiung-Ju Chien	B252	October 29 (2:00pm)	Room H (9F HARUNA)	23
Chuan Li	B229	October 30 (9:00am)	Room G (9F AKAGI)	15
Chuan Li	B230	October 30 (9:00am)	Room G (9F AKAGI)	15
Courtney Powell	SB5202	October 30 (9:00am)	Room E (9F TSUTSUJI-2)	19
D. Frank Hsu	B236	October 30 (9:00am)	Room G (9F AKAGI)	15
David G. Clark	B232	October 30 (9:00am)	Room I (9F MYOGI)	16

<b>Name</b>	<b>ID</b>	<b>Session time</b>	<b>Location</b>	<b>Page</b>
Dennis Batangan	B224	October 30 (11:00am)	Room H (9F HARUNA)	17
Dominik Slezak	SB2203	October 29 (2:00pm)	Room E (9F TSUTSUJI-2)	18
Donghan Li	SB3206	October 30 (11:00am)	Room F (9F ASAMA)	21
Dongxue Lin	SB6204	October 30 (9:00am)	Room F (9F ASAMA)	20
Ebenezer Aggrey	B227	October 31 (1:30pm)	Room E (9F TSUTSUJI-2)	17
Eiko Takagi	B266	October 31 (1:30pm)	Room G (9F AKAGI)	25
Fan Zhang	SB1202	October 29 (4:00pm)	Room E (9F TSUTSUJI-2)	19
Fangqing Gu	SB8203	October 30 (11:00am)	Room E (9F TSUTSUJI-2)	20
Farit Mochamad Afendi	SB3202	October 30 (11:00am)	Room F (9F ASAMA)	21
Faudziah Ahmad	B241	October 30 (11:00am)	Room G (9F AKAGI)	16
Fenfen Wang	B229	October 30 (9:00am)	Room G (9F AKAGI)	15
Feng Duan	SB6204	October 30 (9:00am)	Room F (9F ASAMA)	20
Feng Wang	B281	October 29 (4:00pm)	Room I (9F MYOGI)	24
Francesco Fabris	B218	October 31 (1:30pm)	Room E (9F TSUTSUJI-2)	17
Francisco Castro	B224	October 30 (11:00am)	Room H (9F HARUNA)	17
Fumi Fukaya	B260	October 29 (4:00pm)	Room I (9F MYOGI)	24
G. Morgan	B217	October 30 (9:00am)	Room H (9F HARUNA)	15
G.A. Ford	B217	October 30 (9:00am)	Room H (9F HARUNA)	15
Gang Wang	B230	October 30 (9:00am)	Room G (9F AKAGI)	15
Genshiro A. Sunagawa	SB9205	October 31 (1:30pm)	Room B (8F KEYAKI)	22
Gerald Schaefer	B231	October 30 (11:00am)	Room H (9F HARUNA)	17
Guanghua Jin	B276	October 31 (1:30pm)	Room H (9F HARUNA)	25
Guohun Zhu	B242	October 29 (4:00pm)	Room G (9F AKAGI)	14
H. Rodgers	B217	October 30 (9:00am)	Room H (9F HARUNA)	15
Hagit Shatkay	B222	October 30 (9:00am)	Room I (9F MYOGI)	16
Haibo Hu	SB8203	October 30 (11:00am)	Room E (9F TSUTSUJI-2)	20
Haiping Wei	B215	October 29 (2:00pm)	Room G (9F AKAGI)	14
Haiyan Zhou	B229	October 30 (9:00am)	Room G (9F AKAGI)	15
Haiyan Zhou	B230	October 30 (9:00am)	Room G (9F AKAGI)	15
Hajime Ohyanagi	B251	October 29 (2:00pm)	Room I (9F MYOGI)	23
Hamid Rashid	B251	October 29 (2:00pm)	Room I (9F MYOGI)	23
Han Zhong	SB5203	October 30 (9:00am)	Room E (9F TSUTSUJI-2)	19
Han Zhong	B274	October 29 (2:00pm)	Room H (9F HARUNA)	23
Haruko Iwata	B223	October 30 (9:00am)	Room I (9F MYOGI)	16
He Li	SB1203	October 29 (4:00pm)	Room E (9F TSUTSUJI-2)	19
Herchel Thaddeus Machacon	B268	October 31 (1:30pm)	Room H (9F HARUNA)	25
Hideo Shimizu	B266	October 31 (1:30pm)	Room G (9F AKAGI)	25
Hiroaki Shigemasu	B221	October 29 (2:00pm)	Room G (9F AKAGI)	14
Hirofumi Shimada	HI3	October 31 (1:30pm)	Room D (9F TSUTSUJI-1)	22
Hiroki Matsubayashi	B270	October 31 (1:30pm)	Room G (9F AKAGI)	25
Hiromu Mori	SB6203	October 30 (9:00am)	Room F (9F ASAMA)	20
Hironao Namba	B260	October 29 (4:00pm)	Room I (9F MYOGI)	24
Hiroshi Riquimaroux	B278	October 31 (1:30pm)	Room G (9F AKAGI)	25
Hiroyuki Kido	SB2201	October 29 (2:00pm)	Room E (9F TSUTSUJI-2)	18
Ho Cheung Leung	SB8202	October 30 (11:00am)	Room E (9F TSUTSUJI-2)	20
Ho Wang Lam	SB5204	October 30 (9:00am)	Room E (9F TSUTSUJI-2)	19
Hong Jia	SB8201	October 30 (11:00am)	Room E (9F TSUTSUJI-2)	20
Hong Peng	SB1201	October 29 (4:00pm)	Room E (9F TSUTSUJI-2)	19
Hua Wang	B244	October 30 (9:00am)	Room H (9F HARUNA)	15

<b>Name</b>	<b>ID</b>	<b>Session time</b>	<b>Location</b>	<b>Page</b>
Ichiro Fukumoto	B201	October 31 (1:30pm)	Room E (9F TSUTSUJI-2)	17
Ichiro Sakurai	B202	October 29 (2:00pm)	Room G (9F AKAGI)	14
Ira Puspitasari	B257	October 31 (1:30pm)	Room H (9F HARUNA)	25
J. Serradilla	B217	October 30 (9:00am)	Room H (9F HARUNA)	15
J.A. Eyre	B217	October 30 (9:00am)	Room H (9F HARUNA)	15
J.Q. Shi	B217	October 30 (9:00am)	Room H (9F HARUNA)	15
Jagat Sastry Pudipeddi	B237	October 30 (11:00am)	Room G (9F AKAGI)	16
Jan G. Bjaalie	SBA203	October 29 (2:00pm)	Room B (8F KEYAKI)	18
Jan Treur	B204	October 29 (2:00pm)	Room G (9F AKAGI)	14
Jeroen de Man	B204	October 29 (2:00pm)	Room G (9F AKAGI)	14
Ji Zhang	B244	October 30 (9:00am)	Room H (9F HARUNA)	15
Jia Bei	SB5201	October 30 (9:00am)	Room E (9F TSUTSUJI-2)	19
JiaJia Yang	B211	October 31 (1:30pm)	Room E (9F TSUTSUJI-2)	17
Jian Han	SB5203	October 30 (9:00am)	Room E (9F TSUTSUJI-2)	19
Jian Han	B274	October 29 (2:00pm)	Room H (9F HARUNA)	23
Jian He	B243	October 30 (11:00am)	Room G (9F AKAGI)	16
Jianhui Chen	SB5203	October 30 (9:00am)	Room E (9F TSUTSUJI-2)	19
Jianhui Chen	B274	October 29 (2:00pm)	Room H (9F HARUNA)	23
Jiming Liu	SB8204	October 30 (11:00am)	Room E (9F TSUTSUJI-2)	20
Jing Wang	SB8203	October 30 (11:00am)	Room E (9F TSUTSUJI-2)	20
Jinglong Wu	B211	October 31 (1:30pm)	Room E (9F TSUTSUJI-2)	17
Jingyao Shen	SB6204	October 30 (9:00am)	Room F (9F ASAMA)	20
Jiro Kurata	B261	October 29 (2:00pm)	Room H (9F HARUNA)	23
Joanna Jarmolowska	B218	October 31 (1:30pm)	Room E (9F TSUTSUJI-2)	17
Joshua T. Vogelstein	B237	October 30 (11:00am)	Room G (9F AKAGI)	16
Jun Ohta	SB7203	October 30 (11:00am)	Room I (9F MYOGI)	21
Jun Zhou	B229	October 30 (9:00am)	Room G (9F AKAGI)	15
Jun Zhou	B230	October 30 (9:00am)	Room G (9F AKAGI)	15
Kang-Ming Chang	B252	October 29 (2:00pm)	Room H (9F HARUNA)	23
Katsumi Sakata	B251	October 29 (2:00pm)	Room I (9F MYOGI)	23
Katuhiro Maki	B278	October 31 (1:30pm)	Room G (9F AKAGI)	25
Kazuhiro Uemoto	SB6202	October 30 (9:00am)	Room F (9F ASAMA)	20
Kazuo Arakawa	HI3	October 31 (1:30pm)	Room D (9F TSUTSUJI-1)	22
Kazutomo Yunokuchi	B220	October 30 (9:00am)	Room H (9F HARUNA)	15
Kazuyuki Imamura	B228	October 30 (11:00am)	Room G (9F AKAGI)	16
Kazuyuki Imamura	B270	October 31 (1:30pm)	Room G (9F AKAGI)	25
Keiichi Kitajo	SBA202	October 29 (2:00pm)	Room B (8F KEYAKI)	18
Keisuke Kuboyama	B281	October 29 (4:00pm)	Room I (9F MYOGI)	24
Ken Tanaka	SB3202	October 30 (11:00am)	Room F (9F ASAMA)	21
Ken Tanaka	SB3206	October 30 (11:00am)	Room F (9F ASAMA)	21
Ken-ichi Fukui	B257	October 31 (1:30pm)	Room H (9F HARUNA)	25
Kenji Sakimura	B265	October 29 (4:00pm)	Room H (9F HARUNA)	24
Kenji W Koyano	B271	October 31 (1:30pm)	Room G (9F AKAGI)	25
Kenjiro Fukao	SBA202	October 29 (2:00pm)	Room B (8F KEYAKI)	18
Kensuke Nakamura	SB3202	October 30 (11:00am)	Room F (9F ASAMA)	21
Kensuke Nakamura	SB3203	October 30 (11:00am)	Room F (9F ASAMA)	21
Kenta Hori	SB3201	October 30 (11:00am)	Room F (9F ASAMA)	20
Kentaro Ishige	B251	October 29 (2:00pm)	Room I (9F MYOGI)	23
Khaled Bashir Shaban	B209	October 30 (9:00am)	Room I (9F MYOGI)	16

<b>Name</b>	<b>ID</b>	<b>Session time</b>	<b>Location</b>	<b>Page</b>
Kilby Sanchez	B236	October 30 (9:00am)	Room G (9F AKAGI)	15
King Hong Cheung	SB5204	October 30 (9:00am)	Room E (9F TSUTSUJI-2)	19
Kinshuk	B227	October 31 (1:30pm)	Room E (9F TSUTSUJI-2)	17
Kittisak Kerdprasop	B253	October 31 (1:30pm)	Room H (9F HARUNA)	25
Kiyotaka Sasagawa	SB7203	October 30 (11:00am)	Room I (9F MYOGI)	21
Koichi Moriyama	B257	October 31 (1:30pm)	Room H (9F HARUNA)	25
Koji Noda	HI2	October 31 (1:30pm)	Room D (9F TSUTSUJI-1)	22
Kota Torikai	HI3	October 31 (1:30pm)	Room D (9F TSUTSUJI-1)	22
Kuncheng Li	B229	October 30 (9:00am)	Room G (9F AKAGI)	15
Kyohei Nakayama	B259	October 29 (2:00pm)	Room I (9F MYOGI)	23
L. Rochester	B217	October 30 (9:00am)	Room H (9F HARUNA)	15
Lei Feng	B230	October 30 (9:00am)	Room G (9F AKAGI)	15
Lei Nie	B206	October 29 (4:00pm)	Room G (9F AKAGI)	14
Leman Akoglu	B237	October 30 (11:00am)	Room G (9F AKAGI)	16
Luca Longo	B207	October 30 (9:00am)	Room H (9F HARUNA)	15
Lucy Hederman	B207	October 30 (9:00am)	Room H (9F HARUNA)	15
Lukasz Sosnowski	SB2203	October 29 (2:00pm)	Room E (9F TSUTSUJI-2)	18
Ma. Regina Estuar	B224	October 30 (11:00am)	Room H (9F HARUNA)	17
Maiga Chang	B227	October 31 (1:30pm)	Room E (9F TSUTSUJI-2)	17
Makito Haruta	SB7203	October 30 (11:00am)	Room I (9F MYOGI)	21
Makoto Sakai	HI3	October 31 (1:30pm)	Room D (9F TSUTSUJI-1)	22
Manel Sghir	B272	October 29 (2:00pm)	Room I (9F MYOGI)	23
Marcello Turconi	B218	October 31 (1:30pm)	Room E (9F TSUTSUJI-2)	17
Martin Schlueter	SB5202	October 30 (9:00am)	Room E (9F TSUTSUJI-2)	19
Masaharu Munetomo	SB5202	October 30 (9:00am)	Room E (9F TSUTSUJI-2)	19
Masahiro Akimoto	SB2201	October 29 (2:00pm)	Room E (9F TSUTSUJI-2)	18
Masahiro Kawasaki	SBA202	October 29 (2:00pm)	Room B (8F KEYAKI)	18
Masaki Takeda	B271	October 31 (1:30pm)	Room G (9F AKAGI)	25
Masaki Tamada	SB2201	October 29 (2:00pm)	Room E (9F TSUTSUJI-2)	18
Masanori Arita	SB3207	October 30 (11:00am)	Room F (9F ASAMA)	21
Masanori Fujimoto	SB2201	October 29 (2:00pm)	Room E (9F TSUTSUJI-2)	18
Masanori Yamato	B276	October 31 (1:30pm)	Room H (9F HARUNA)	25
Masanori Yamato	B278	October 31 (1:30pm)	Room G (9F AKAGI)	25
Masashi Yanagisawa	SB9204	October 31 (1:30pm)	Room B (8F KEYAKI)	22
Masataka Mizukoshi	SB5202	October 30 (9:00am)	Room E (9F TSUTSUJI-2)	19
Masataka Yoshioka	SB6202	October 30 (9:00am)	Room F (9F ASAMA)	20
Masato Odagaki	B220	October 30 (9:00am)	Room H (9F HARUNA)	15
Masayuki Kobayashi	B269	October 31 (1:30pm)	Room G (9F AKAGI)	25
Masayuki Nakano	B276	October 31 (1:30pm)	Room H (9F HARUNA)	25
Masayuki Numao	B257	October 31 (1:30pm)	Room H (9F HARUNA)	25
Mayumi Motoyama	SB7203	October 30 (11:00am)	Room I (9F MYOGI)	21
Md. Altaf-Ul-Amin	SB3204	October 30 (11:00am)	Room F (9F ASAMA)	21
Md. Altaf-Ul-Amin	SB3202	October 30 (11:00am)	Room F (9F ASAMA)	21
Mehadi Sayed	B227	October 31 (1:30pm)	Room E (9F TSUTSUJI-2)	17
Mehdi Snene	B272	October 29 (2:00pm)	Room I (9F MYOGI)	23
Melih C. Ince	B247	October 29 (2:00pm)	Room H (9F HARUNA)	23
Mi Li	B215	October 29 (2:00pm)	Room G (9F AKAGI)	14
Michael Lazarus	SB9203	October 31 (1:30pm)	Room B (8F KEYAKI)	22
Michio Niwano	B202	October 29 (2:00pm)	Room G (9F AKAGI)	14

<b>Name</b>	<b>ID</b>	<b>Session time</b>	<b>Location</b>	<b>Page</b>
Ming Huang	SB3205	October 30 (11:00am)	Room F (9F ASAMA)	21
Mingqi Zhao	SB1201	October 29 (4:00pm)	Room E (9F TSUTSUJI-2)	19
Misato Tanaka	B226	October 30 (9:00am)	Room G (9F AKAGI)	15
Misato Tanaka	B258	October 29 (4:00pm)	Room H (9F HARUNA)	24
Mitsutaka Yamaguchi	HI3	October 31 (1:30pm)	Room D (9F TSUTSUJI-1)	22
Muneaki Ohshima	B239	October 30 (11:00am)	Room H (9F HARUNA)	17
Murat Karabatak	B279	October 29 (2:00pm)	Room I (9F MYOGI)	23
Murat Seckin Ayhan	B219	October 29 (4:00pm)	Room G (9F AKAGI)	14
Mutsumi Tashiro	HI3	October 31 (1:30pm)	Room D (9F TSUTSUJI-1)	22
Muyang Song	SB5201	October 30 (9:00am)	Room E (9F TSUTSUJI-2)	19
Nacéra Benamrane	B234	October 29 (4:00pm)	Room H (9F HARUNA)	24
Na Li	SB1201	October 29 (4:00pm)	Room E (9F TSUTSUJI-2)	19
Naoaki Ono	SB3202	October 30 (11:00am)	Room F (9F ASAMA)	21
Naoaki Ono	SB3204	October 30 (11:00am)	Room F (9F ASAMA)	21
Naoaki Ono	SB3206	October 30 (11:00am)	Room F (9F ASAMA)	21
Naoki Kawachi	HI3	October 31 (1:30pm)	Room D (9F TSUTSUJI-1)	22
Natsume Tanaka	HI4	October 31 (1:30pm)	Room D (9F TSUTSUJI-1)	22
Natsume Tanaka	B245	October 31 (1:30pm)	Room G (9F AKAGI)	25
Nelson Kibinge	SB3204	October 30 (11:00am)	Room F (9F ASAMA)	21
Ning Zhong	B215	October 29 (2:00pm)	Room G (9F AKAGI)	14
Ning Zhong	B242	October 29 (4:00pm)	Room G (9F AKAGI)	14
Ning Zhong	B229	October 30 (9:00am)	Room G (9F AKAGI)	15
Ning Zhong	B230	October 30 (9:00am)	Room G (9F AKAGI)	15
Ning Zhong	B228	October 30 (11:00am)	Room G (9F AKAGI)	16
Ning Zhong	B239	October 30 (11:00am)	Room H (9F HARUNA)	17
Ning Zhong	SB5203	October 30 (9:00am)	Room E (9F TSUTSUJI-2)	19
Ning Zhong	B274	October 29 (2:00pm)	Room H (9F HARUNA)	23
Ning Zhong	B273	October 29 (4:00pm)	Room H (9F HARUNA)	24
Nittaya Kerdprasop	B253	October 31 (1:30pm)	Room H (9F HARUNA)	25
Nobuhiko Kojima	HI4	October 31 (1:30pm)	Room D (9F TSUTSUJI-1)	22
Nobuhiko Kojima	B265	October 29 (4:00pm)	Room H (9F HARUNA)	24
Nobuhiko Kojima	B245	October 31 (1:30pm)	Room G (9F AKAGI)	25
Noriko Koganezawa	HI4	October 31 (1:30pm)	Room D (9F TSUTSUJI-1)	22
Noriko Koganezawa	B245	October 31 (1:30pm)	Room G (9F AKAGI)	25
Omer F. Alcin	B247	October 29 (2:00pm)	Room H (9F HARUNA)	23
Pei-Jung Yang	B208	October 31 (1:30pm)	Room E (9F TSUTSUJI-2)	17
Peng (Paul) Wen	B242	October 29 (4:00pm)	Room G (9F AKAGI)	14
Pengfei Liu	B215	October 29 (2:00pm)	Room G (9F AKAGI)	14
Pengfei Yan	B221	October 29 (2:00pm)	Room G (9F AKAGI)	14
Piero Paolo Battaglini	B218	October 31 (1:30pm)	Room E (9F TSUTSUJI-2)	17
Qinglin Zhao	SB1201	October 29 (4:00pm)	Room E (9F TSUTSUJI-2)	19
Quanying Liu	SB1201	October 29 (4:00pm)	Room E (9F TSUTSUJI-2)	19
Quazi Abidur Rahman	B222	October 30 (9:00am)	Room I (9F MYOGI)	16
R. Jacob Vogelstein	B237	October 30 (11:00am)	Room G (9F AKAGI)	16
Ramesh Katam	B251	October 29 (2:00pm)	Room I (9F MYOGI)	23
Ramon Mejia	SB3207	October 30 (11:00am)	Room F (9F ASAMA)	21
Reiko T. Roppongi	B266	October 31 (1:30pm)	Room G (9F AKAGI)	25
Rex E. Jung	B237	October 30 (11:00am)	Room G (9F AKAGI)	16
Risako Kato	B269	October 31 (1:30pm)	Room G (9F AKAGI)	25

<b>Name</b>	<b>ID</b>	<b>Session time</b>	<b>Location</b>	<b>Page</b>
Roussanka Loukanova	SB2204	October 29 (2:00pm)	Room E (9F TSUTSUJI-2)	19
Rui Gao	SB1203	October 29 (4:00pm)	Room E (9F TSUTSUJI-2)	19
Ryan G. Benton	B219	October 29 (4:00pm)	Room G (9F AKAGI)	14
Ryan G. Benton	B232	October 30 (9:00am)	Room I (9F MYOGI)	16
Ryoko Fujimichi	B271	October 31 (1:30pm)	Room G (9F AKAGI)	25
Sachiko Tanaami	HI4	October 31 (1:30pm)	Room D (9F TSUTSUJI-1)	22
Sachiko Tanaami	B245	October 31 (1:30pm)	Room G (9F AKAGI)	25
Sadao Shiosaka	SB7203	October 30 (11:00am)	Room I (9F MYOGI)	21
Sakiko Ogoshi	SB6205	October 30 (9:00am)	Room F (9F ASAMA)	20
Salmah F.A. Alsgaer	B244	October 30 (9:00am)	Room H (9F HARUNA)	15
Sami Ekici	B280	October 29 (2:00pm)	Room I (9F MYOGI)	23
Satoru Yamada	HI3	October 31 (1:30pm)	Room D (9F TSUTSUJI-1)	22
Satoshi Kume	B276	October 31 (1:30pm)	Room H (9F HARUNA)	25
Satoshi Takahashi	B211	October 31 (1:30pm)	Room E (9F TSUTSUJI-2)	17
Seiichiro Ohno	B211	October 31 (1:30pm)	Room E (9F TSUTSUJI-2)	17
Sephira Ryman	B237	October 30 (11:00am)	Room G (9F AKAGI)	16
Setsuko Komatsu	B251	October 29 (2:00pm)	Room I (9F MYOGI)	23
Shang Xia	SB8204	October 30 (11:00am)	Room E (9F TSUTSUJI-2)	20
Shao Ying Zhu	B231	October 30 (11:00am)	Room H (9F HARUNA)	17
Shengfu Lu	B215	October 29 (2:00pm)	Room G (9F AKAGI)	14
Sheung Wai Chan	SB8202	October 30 (11:00am)	Room E (9F TSUTSUJI-2)	20
Shigehiko Kanaya	SB3202	October 30 (11:00am)	Room F (9F ASAMA)	21
Shigehiko Kanaya	SB3204	October 30 (11:00am)	Room F (9F ASAMA)	21
Shigehiko Kanaya	SB3206	October 30 (11:00am)	Room F (9F ASAMA)	21
Shigeru Kubota	B202	October 29 (2:00pm)	Room G (9F AKAGI)	14
Shin Watanabe	HI3	October 31 (1:30pm)	Room D (9F TSUTSUJI-1)	22
Shin'ei Noda	HI3	October 31 (1:30pm)	Room D (9F TSUTSUJI-1)	22
Shinichi Mitsui	SB7202	October 30 (11:00am)	Room I (9F MYOGI)	21
Shinichi Motomura	B239	October 30 (11:00am)	Room H (9F HARUNA)	17
Shin'ichiro Takeda	HI3	October 31 (1:30pm)	Room D (9F TSUTSUJI-1)	22
Shinji Kakei	SBA204	October 29 (2:00pm)	Room B (8F KEYAKI)	18
Shinobu Masaki	SBA205	October 29 (2:00pm)	Room B (8F KEYAKI)	18
Shiro Usui	SBA201	October 29 (2:00pm)	Room B (8F KEYAKI)	18
Shogo Obuchi	B226	October 30 (9:00am)	Room G (9F AKAGI)	15
Shoji Hirano	B223	October 30 (9:00am)	Room I (9F MYOGI)	16
Shoji Hirano	SB2206	October 29 (2:00pm)	Room E (9F TSUTSUJI-2)	19
Shoji Makino	SB6203	October 30 (9:00am)	Room F (9F ASAMA)	20
Shuaifang Wang	B242	October 29 (4:00pm)	Room G (9F AKAGI)	14
Shuhei Horio	B251	October 29 (2:00pm)	Room I (9F MYOGI)	23
Shulin Yan	B206	October 29 (4:00pm)	Room G (9F AKAGI)	14
Shun Ikeda	SB3202	October 30 (11:00am)	Room F (9F ASAMA)	21
Shun Ikeda	SB3204	October 30 (11:00am)	Room F (9F ASAMA)	21
Shuo Zhang	B261	October 29 (2:00pm)	Room H (9F HARUNA)	23
Shusaku Tsumoto	B223	October 30 (9:00am)	Room I (9F MYOGI)	16
Shusaku Tsumoto	SB2206	October 29 (2:00pm)	Room E (9F TSUTSUJI-2)	19
Sih-Huei Chen	B252	October 29 (2:00pm)	Room H (9F HARUNA)	23
Sivajothi Kanagalingam	B222	October 30 (9:00am)	Room I (9F MYOGI)	16
Suresh Choubey	B219	October 29 (4:00pm)	Room G (9F AKAGI)	14
Suresh Choubey	B232	October 30 (9:00am)	Room I (9F MYOGI)	16



<b>Name</b>	<b>ID</b>	<b>Session time</b>	<b>Location</b>	<b>Page</b>
Susumu Kanazawa	B211	October 31 (1:30pm)	Room E (9F TSUTSUJI-2)	17
T. Cassidy	B217	October 30 (9:00am)	Room H (9F HARUNA)	15
Tadayuki Takahashi	HI3	October 31 (1:30pm)	Room D (9F TSUTSUJI-1)	22
Taihei Kotake	SB5203	October 30 (9:00am)	Room E (9F TSUTSUJI-2)	19
Taihei Kotake	B274	October 29 (2:00pm)	Room H (9F HARUNA)	23
Takahiro Yoshihara	B270	October 31 (1:30pm)	Room G (9F AKAGI)	25
Takashi Matsumoto	B260	October 29 (4:00pm)	Room I (9F MYOGI)	24
Takashi Nakamura	B260	October 29 (4:00pm)	Room I (9F MYOGI)	24
Takashi Nakano	HI1	October 31 (1:30pm)	Room D (9F TSUTSUJI-1)	22
Takashi Nakano	HI3	October 31 (1:30pm)	Room D (9F TSUTSUJI-1)	22
Takashi Nakano	HI4	October 31 (1:30pm)	Room D (9F TSUTSUJI-1)	22
Takashi Tokuda	SB7203	October 30 (11:00am)	Room I (9F MYOGI)	21
Takeshi Sakurai	SB9202	October 31 (1:30pm)	Room B (8F KEYAKI)	22
Taleb-Ahmed Adbelmalik	B234	October 29 (4:00pm)	Room H (9F HARUNA)	24
Tatsuaki Kanai	HI3	October 31 (1:30pm)	Room D (9F TSUTSUJI-1)	22
Teppe Matsui	B271	October 31 (1:30pm)	Room G (9F AKAGI)	25
Teruaki Hayashi	SB2201	October 29 (2:00pm)	Room E (9F TSUTSUJI-2)	18
Tetsuo Katsuragi	SB3202	October 30 (11:00am)	Room F (9F ASAMA)	21
Tetsuo Sato	SB3201	October 30 (11:00am)	Room F (9F ASAMA)	20
Tetsuya Asakawa	B212	October 30 (11:00am)	Room H (9F HARUNA)	17
Tetsuya Murai	SB2202	October 29 (2:00pm)	Room E (9F TSUTSUJI-2)	18
Theodore Abraham	B222	October 30 (9:00am)	Room I (9F MYOGI)	16
Tianyi Yan	B211	October 31 (1:30pm)	Room E (9F TSUTSUJI-2)	17
Tibor Bosse	B204	October 29 (2:00pm)	Room G (9F AKAGI)	14
Tingshao Zhu	SB1202	October 29 (4:00pm)	Room E (9F TSUTSUJI-2)	19
Tingshao Zhu	SB1203	October 29 (4:00pm)	Room E (9F TSUTSUJI-2)	19
Tom Johnsten	B232	October 30 (9:00am)	Room I (9F MYOGI)	16
Tomasz Rutkowski	SB6203	October 30 (9:00am)	Room F (9F ASAMA)	20
Tomihiro Kamiya	HI3	October 31 (1:30pm)	Room D (9F TSUTSUJI-1)	22
Tomoaki Shirao	HI4	October 31 (1:30pm)	Room D (9F TSUTSUJI-1)	22
Tomoaki Shirao	B265	October 29 (4:00pm)	Room H (9F HARUNA)	24
Tomoaki Shirao	B245	October 31 (1:30pm)	Room G (9F AKAGI)	25
Tomoaki Shirao	B266	October 31 (1:30pm)	Room G (9F AKAGI)	25
Tomohiro Takezawa	SB6205	October 30 (9:00am)	Room F (9F ASAMA)	20
Tomohisa Okada	SB3201	October 30 (11:00am)	Room F (9F ASAMA)	20
Tomoyoshi Soga	B276	October 31 (1:30pm)	Room H (9F HARUNA)	25
Tomoyuki Hiroyasu	B225	October 29 (4:00pm)	Room G (9F AKAGI)	14
Tomoyuki Hiroyasu	B226	October 30 (9:00am)	Room G (9F AKAGI)	15
Tomoyuki Hiroyasu	B255	October 29 (4:00pm)	Room H (9F HARUNA)	24
Tomoyuki Hiroyasu	B258	October 29 (4:00pm)	Room H (9F HARUNA)	24
Tongwei Ren	SB5201	October 30 (9:00am)	Room E (9F TSUTSUJI-2)	19
Toshihiko Noda	SB7203	October 30 (11:00am)	Room I (9F MYOGI)	21
Toshiko Yoshida	B212	October 30 (11:00am)	Room H (9F HARUNA)	17
Toshimitsu Musha	B261	October 29 (2:00pm)	Room H (9F HARUNA)	23
Toshiya Murai	SBA202	October 29 (2:00pm)	Room B (8F KEYAKI)	18
Toshiyuki Taura	B220	October 30 (9:00am)	Room H (9F HARUNA)	15
Tsung-Han Chang	B208	October 31 (1:30pm)	Room E (9F TSUTSUJI-2)	17
Tsuyoshi Shirai	SB3202	October 30 (11:00am)	Room F (9F ASAMA)	21
Tsz Wa Ho	SB5204	October 30 (9:00am)	Room E (9F TSUTSUJI-2)	19

<b>Name</b>	<b>ID</b>	<b>Session time</b>	<b>Location</b>	<b>Page</b>
Utako Yamamoto	B225	October 29 (4:00pm)	Room G (9F AKAGI)	14
Utako Yamamoto	B226	October 30 (9:00am)	Room G (9F AKAGI)	15
Utako Yamamoto	B255	October 29 (4:00pm)	Room H (9F HARUNA)	24
Utako Yamamoto	B258	October 29 (4:00pm)	Room H (9F HARUNA)	24
Vijay V. Raghavan	B219	October 29 (4:00pm)	Room G (9F AKAGI)	14
Vijay V. Raghavan	B232	October 30 (9:00am)	Room I (9F MYOGI)	16
Vivek Kulkarni	B237	October 30 (11:00am)	Room G (9F AKAGI)	16
Weiquan Gu	B254	October 29 (4:00pm)	Room H (9F HARUNA)	24
Wenyu Li	SB6204	October 30 (9:00am)	Room F (9F ASAMA)	20
Xiangsheng Shen	B229	October 30 (9:00am)	Room G (9F AKAGI)	15
Xiaohui Tao	B244	October 30 (9:00am)	Room H (9F HARUNA)	15
Xiuzhen Wang	B254	October 29 (4:00pm)	Room H (9F HARUNA)	24
Xingyu Su	B215	October 29 (2:00pm)	Room G (9F AKAGI)	14
Xiuya Lei	B228	October 30 (11:00am)	Room G (9F AKAGI)	16
Xuegang Hu	SB8203	October 30 (11:00am)	Room E (9F TSUTSUJI-2)	20
Y. Cheng	B217	October 30 (9:00am)	Room H (9F HARUNA)	15
Yan Li	B242	October 29 (4:00pm)	Room G (9F AKAGI)	14
Yan Liu	SB5201	October 30 (9:00am)	Room E (9F TSUTSUJI-2)	19
Yang Yang	B228	October 30 (11:00am)	Room G (9F AKAGI)	16
Yasuhiro Ogoshi	SB6205	October 30 (9:00am)	Room F (9F ASAMA)	20
Yasuhisa Tamura	B276	October 31 (1:30pm)	Room H (9F HARUNA)	25
Yasuhisa Tamura	B278	October 31 (1:30pm)	Room G (9F AKAGI)	25
Yasuko Funabiki	SBA202	October 29 (2:00pm)	Room B (8F KEYAKI)	18
Yasumasa Hitomi	B212	October 30 (11:00am)	Room H (9F HARUNA)	17
Yasumi Ohta	SB7203	October 30 (11:00am)	Room I (9F MYOGI)	21
Yasuo Kudo	SB2202	October 29 (2:00pm)	Room E (9F TSUTSUJI-2)	18
Yasushi Miyashita	B271	October 31 (1:30pm)	Room G (9F AKAGI)	25
Yasutomo Nomura	B259	October 29 (2:00pm)	Room I (9F MYOGI)	23
Yasuyuki Ishikawa	SB7201	October 30 (11:00am)	Room I (9F MYOGI)	21
Yasuyuki Ishikawa	SB7203	October 30 (11:00am)	Room I (9F MYOGI)	21
Yee Ling Boo	B277	October 29 (4:00pm)	Room I (9F MYOGI)	24
Yike Guo	B206	October 29 (4:00pm)	Room G (9F AKAGI)	14
Yiu-ming Cheung	SB8201	October 30 (11:00am)	Room E (9F TSUTSUJI-2)	20
Yiu-ming Cheung	SB8203	October 30 (11:00am)	Room E (9F TSUTSUJI-2)	20
Yohei Kobayashi	B261	October 29 (2:00pm)	Room H (9F HARUNA)	23
Yohei Ohashi	B271	October 31 (1:30pm)	Room G (9F AKAGI)	25
Yoko Yamaguchi	SBA201	October 29 (2:00pm)	Room B (8F KEYAKI)	18
Yoko Yamaguchi	SBA202	October 29 (2:00pm)	Room B (8F KEYAKI)	18
Yoshifumi Okada	SB2202	October 29 (2:00pm)	Room E (9F TSUTSUJI-2)	18
Yoshihiro Tsuji	B212	October 30 (11:00am)	Room H (9F HARUNA)	17
Yoshihiro Urade	SB9201	October 31 (1:30pm)	Room B (8F KEYAKI)	22
Yoshiki Kubota	HI3	October 31 (1:30pm)	Room D (9F TSUTSUJI-1)	22
Yoshiko Yabe	B221	October 29 (2:00pm)	Room G (9F AKAGI)	14
Yoshinori Mitsuhasi	SB6205	October 30 (9:00am)	Room F (9F ASAMA)	20
Yoshiyuki Suzuki	HI3	October 31 (1:30pm)	Room D (9F TSUTSUJI-1)	22
Yoshiyuki Suzuki	HI4	October 31 (1:30pm)	Room D (9F TSUTSUJI-1)	22
Yosky Kataoka	B276	October 31 (1:30pm)	Room H (9F HARUNA)	25
Yosky Kataoka	B278	October 31 (1:30pm)	Room G (9F AKAGI)	25
Yu Zhou	B215	October 29 (2:00pm)	Room G (9F AKAGI)	14

<b>Name</b>	<b>ID</b>	<b>Session time</b>	<b>Location</b>	<b>Page</b>
Yuan Feng	B230	October 30 (9:00am)	Room G (9F AKAGI)	15
Yuichiro Yoshikawa	SB6202	October 30 (9:00am)	Room F (9F ASAMA)	20
Yukari Yoshida	HI3	October 31 (1:30pm)	Room D (9F TSUTSUJI-1)	22
Yuki Kajita	B265	October 29 (4:00pm)	Room H (9F HARUNA)	24
Yuki Otana	SB3202	October 30 (11:00am)	Room F (9F ASAMA)	21
Yukiharu Miyashige	B276	October 31 (1:30pm)	Room H (9F HARUNA)	25
Yukiko Nakamura	SB3202	October 30 (11:00am)	Room F (9F ASAMA)	21
Yukio Kosugi	B261	October 29 (2:00pm)	Room H (9F HARUNA)	23
Yukio Ohsawa	SB2201	October 29 (2:00pm)	Room E (9F TSUTSUJI-2)	18
Yuko Mizuno-Matsumoto	B212	October 30 (11:00am)	Room H (9F HARUNA)	17
Yulin Qin	B229	October 30 (9:00am)	Room G (9F AKAGI)	15
Yulin Qin	B230	October 30 (9:00am)	Room G (9F AKAGI)	15
Yuri Watanabe	B261	October 29 (2:00pm)	Room H (9F HARUNA)	23
Yushu Guo	B273	October 29 (4:00pm)	Room H (9F HARUNA)	24
Yusong Gao	SB1203	October 29 (4:00pm)	Room E (9F TSUTSUJI-2)	19
Yuta Ishizuka	B266	October 31 (1:30pm)	Room G (9F AKAGI)	25
Yutaka Kikuchi	B220	October 30 (9:00am)	Room H (9F HARUNA)	15
Yuu Hikino	B211	October 31 (1:30pm)	Room E (9F TSUTSUJI-2)	17
Yuuto Nagao	HI3	October 31 (1:30pm)	Room D (9F TSUTSUJI-1)	22
Zhi Guo	B244	October 30 (9:00am)	Room H (9F HARUNA)	15
Zhihong Zhao	SB5201	October 30 (9:00am)	Room E (9F TSUTSUJI-2)	19
Zhijiang Wan	B243	October 30 (11:00am)	Room G (9F AKAGI)	16
Zhisheng Huang	SB5203	October 30 (9:00am)	Room E (9F TSUTSUJI-2)	19
Zhisheng Huang	B274	October 29 (2:00pm)	Room H (9F HARUNA)	23
Zhizhou Liao	B230	October 30 (9:00am)	Room G (9F AKAGI)	15
Zhong-Qiu Zhao	SB8203	October 30 (11:00am)	Room E (9F TSUTSUJI-2)	20
Zhoujun Long	B229	October 30 (9:00am)	Room G (9F AKAGI)	15